



SBS71XZA



# CONTENTS

<b>1</b>	<b>SAFETY FIRST</b>	<b>PAGE</b>
1.1	Warning	1
1.2	Meanings of safety warning symbols	1
1.3	Electricity related warnings	2
1.4	Usage Appliance	2 to 3
1.5	Placement of items	3
1.6	Disposal	3
<b>2</b>	<b>PROPER USE OF REFRIGERATOR</b>	<b>PAGE</b>
2.1	Placement	4
2.2	Levelling Feet	5
2.3	Levelling Door	5
2.4	Changing the Light	6
2.5	Starting	6
2.6	Energy Saving	6
<b>3</b>	<b>PROPER USE OF REFRIGERATOR</b>	<b>PAGE</b>
3.1	Key Components	7 to 8
3.2	Display Functions	9 to 11
3.3	Dispensing Water and Ice	12 to 13
<b>4</b>	<b>PROPER USE OF REFRIGERATOR</b>	<b>PAGE</b>
4.1	Overall Cleaning	14
4.2	Cleaning of the door tray	15
4.3	Cleaning the Ice Container	15 to 16
4.4	Cleaning of the glass shelves	16
4.5	Cleaning of lattice and water pipes	16
4.6	Defrosting	17
4.7	Out of Operation	17
4.8	Moving	17
<b>5</b>	<b>PROPER USE OF REFRIGERATOR</b>	<b>PAGE</b>
5.1	Trouble Shooting	18 to 19
<b>6</b>	<b>CONTACT INFORMATION</b>	
6.1	Contact Us	

# 1. SAFETY FIRST

## 1.1 Warning and Safety Information

Please read the operating and installation instructions carefully! They contain important information on how to install, use and maintain the appliance. The manufacturer is not liable if you fail to comply with the instructions and warnings.

This appliance is intended to be used in household and similar applications such as staff kitchen areas in shops, offices and other working environments; farm houses and by clients in hotels, motels and other residential type environments; bed and breakfast type environments; non- retail or commercial catering applications.

The appliance must be unplugged if not in use and before carrying out user maintenance on the appliance or the installation of an accessory.

Do not use electrical appliances inside the food storage compartments of the appliance.

Refrigerant and cyclopentane foaming material used for the appliance are flammable. Therefore, when the appliance is scrapped, it shall be kept away from any fire source and be recovered by a special recovering company with corresponding qualification other than be disposed by combustion, so as to prevent damage to the environment or any other harm.

If damage has occurred and refrigerant escapes, keep naked flames and/or ignition sources away from the appliance, thoroughly ventilate the room for several minutes, switch off the appliance and pull out the mains plug and contact the customer service department.

To avoid contamination of food, please respect the following instructions:

Opening the door for long periods can cause a significant increase of the temperature in the compartments of the appliance.

Clean surfaces regularly and accessible drainage systems.

Store raw meat and fish in suitable containers in the refrigerator, so that it is not in contact or may drip onto other food.

If the refrigerating appliance is left empty for long periods, switch off, defrost, clean, dry, and leave the door open to prevent mold developing within the appliance.

## 1.2 Meaning of safety warning symbols



This is a prohibition symbol.

Any incomppliance with instructions marked with this symbol may result in damage to the product or endanger the personal safety of the user.



This is a warning symbol.

It is required to operate in strict observance of instructions marked with this symbol; or otherwise damage to the product or personal injury may be caused.



This is a cautioning symbol.

Instructions marked with this symbol require special caution. Insufficient caution may result in slight or moderate injury, or damage to the product.

This manual contains lots of important safety information which shall be observed by the users.

## 1.3 Electricity related warnings

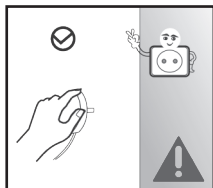

- Do not pull the power cord when pulling the power plug of the refrigerator. Please firmly grasp the plug and pull out from the socket directly.
- To ensure safe use, do not damage the power cord and do not use appliance if the power cord is damaged or worn.
- If supply cord is damaged, it must be replaced by the manufacturer, its service agent or similarly qualified persons in order to avoid a hazard.
- Do not locate multiple portable socket-outlets or portable power supplies at the rear of the appliance.
- Do not use extension cords or ungrounded adapters.

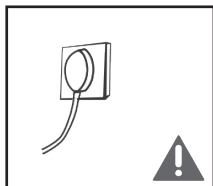

- Please use a dedicated power socket. The power socket shall not be shared with other electrical appliances. The power plug should be firmly contacted with the socket or else fires might be caused.
- Please ensure that the grounding electrode of the power socket is equipped with a reliable grounding line.

## 1.4 Using Appliance

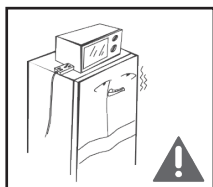

- Do not use electrical appliances on the top of the appliance.

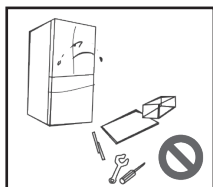

- Do not disassemble or reconstruct the refrigerator, nor damage the refrigerant circuit; maintenance of the appliance must be conducted by a specialist.
- Damaged power cord must be replaced by the manufacturer, its maintenance department or related professionals in order to avoid danger.
- Do not damage the refrigerant circuit.

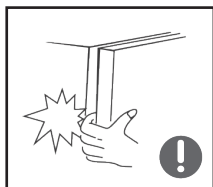

- The gaps between refrigerator doors and between doors and refrigerator body are small, be noted not to put your hand in these areas to prevent from squeezing the finger. Please be gentle when closing the refrigerator door to avoid falling articles.
- Do not pick foods or containers with wet hands in the freezing chamber when the refrigerator is running, especially metal containers in order to avoid frostbite.



- Do not allow any child to get into or climb the refrigerator; otherwise suffocation or a falling injury of the child may be caused.
- Children under the age of 8 years should have adult supervision

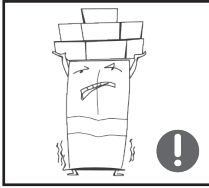

- Do not place heavy objects on the top of the refrigerator considering that objects may fall when closing or opening the door, and accidental injuries might be caused.
- Please pull out the plug during the cleaning process and wait five minutes before re-activating the power supply to prevent damages to the compressor due to successive starts.

## 1.5 Placement of items

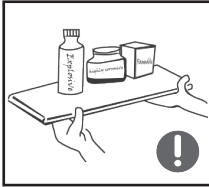

- Do not put flammable, explosive, volatile and highly corrosive items in the refrigerator to prevent damages to the product or fire accidents.
- Do not place flammable items near the refrigerator to avoid fires

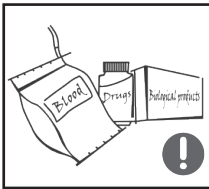

- The refrigerator is intended for household use, such as storage of foods and shall not be used for other purposes, such as storage of blood, drugs, or biological products, etc.

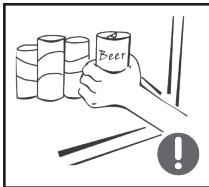

- Do not store beer, beverage or other fluid contained in bottles or enclosed container in the freezing chamber of the refrigerator; or otherwise the bottles or enclosed containers may crack due to freezing and cause damages.

## 1.6 Disposal

Refrigerant and cyclopentane foaming material used for the refrigerator are flammable. Therefore, when the refrigerator is scrapped, it shall be kept away from any fire source and be recovered by a special recovering company with corresponding qualification other than be disposed by combustion, so as to prevent damage to the environment or any other harm.

When the refrigerator is scrapped, disassemble the doors, and remove gasket of door and shelves; put the doors and shelves in a proper place, so as to prevent trapping of any child.



Correct Disposal of this product:

This marking indicates that this product should not be disposed with other household wastes throughout South Africa. To prevent possible harm to the environment or human health from uncontrolled waste disposal, recycle it responsibly to promote the sustainable reuse of material resources.

## 2. PROPER USE OF REFRIGERATORS

### 2.1 Placement

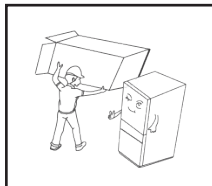

- Before use, remove all packing materials, including bottom cushions, foam pads and tapes inside of the refrigerator; tear off the protective film on the doors and the refrigerator body.

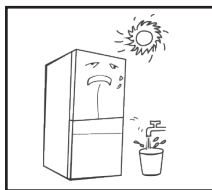

- Keep away from heat and avoid direct sunlight. Do not place the freezer in moist or watery places to prevent rust or reduction of insulating effect.

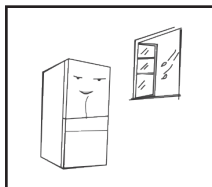

- The refrigerator is placed in a well-ventilated indoor place; the ground shall be flat, and sturdy (rotate left or right to adjust the wheel for levelling if unstable).

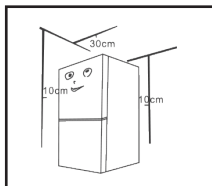

- The top space of the refrigerator shall be greater than 30cm, and the refrigerator should be placed against a wall with a free distance more than 10cm to facilitate the heat dissipation.

### Precautions before installation:

Before installation or adjusting of accessories, it shall be ensured that the refrigerator is disconnected from power. Precautions shall be taken to prevent fall of the handle from causing any personal injury.

When positioning the appliance, ensure the supply cord is not trapped or damaged.

## 2.2 Levelling feet

Graphic diagram of the levelling feet

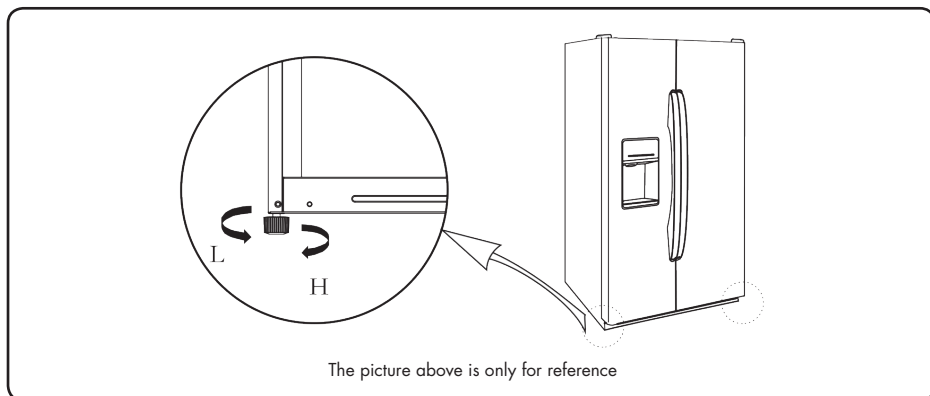

### Adjusting procedures:

1. Turn the feet clockwise to raise the refrigerator;
2. Turn the feet counterclockwise to lower the refrigerator;
3. Adjust the right and left feet based on the procedures above to a horizontal level.

## 2.3 Levelling door

Graphic diagram of leveling the door

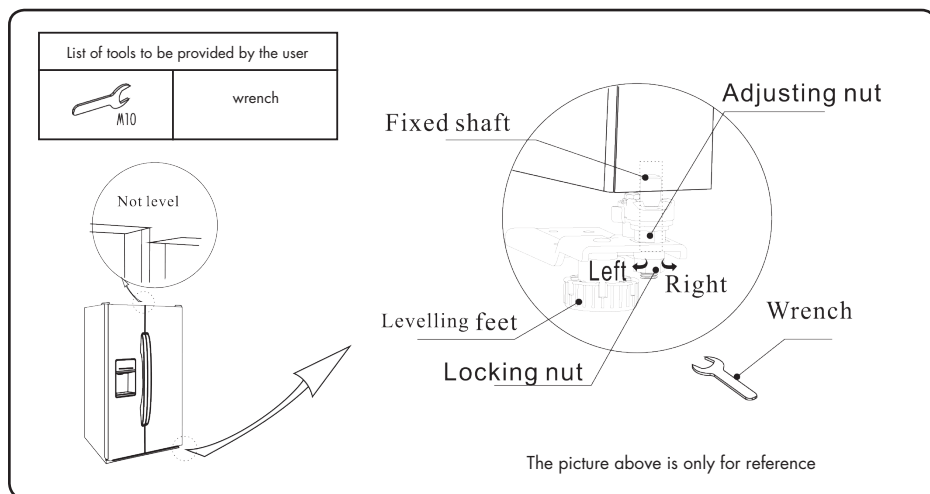

### When the fridge door is low:

Open the door, use the wrench to loosen the locking nut and to rotate the adjusting nut anti-clockwise to raise the height of the door. Once the doors are aligned, then tighten the locking nut by rotating it anti-clockwise.

### When the fridge door is high:

Open the door, use the wrench to rotate the adjusting nut clockwise to lower the height of the door. Once the doors are aligned, then tighten the locking nut by rotating it anti-clockwise.



## 2.4 Changing the Light

Any replacement or maintenance of the LED lamps is intended to be made by the manufacturer, its service agent or similar qualified person.

## 2.5 Starting to use

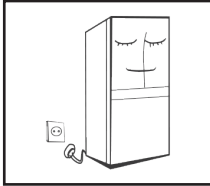

- Before initial start, keep the refrigerator still for two hours before connecting it to power supply.
- Before putting any fresh or frozen foods, the refrigerator shall have run for 2-3 hours, or for above 4 hours in summer when the ambient temperature is high.

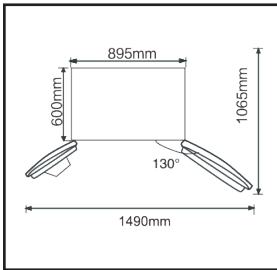

- Ensure enough space for convenient opening of the doors and drawers.

## 2.6 Energy saving tips

- The appliance should be placed in the coolest area of the room, away from heat producing appliances or heating ducts, and out of the direct sunlight.
- Let hot foods cool to room temperature before placing in the appliance.
- Overloading the appliance forces the compressor to run longer. Foods that freeze too slowly may lose quality or spoil.
- Be sure to wrap foods properly, and wipe containers dry before placing them in the appliance. This cuts down on frost build-up inside the appliance.
- Appliance storage bin should not be lined with aluminum foil, wax paper, or paper toweling. Liners interfere with cold air circulation, making the appliance less efficient.
- Organize and label food to reduce door openings and extended searches. Remove as many items as needed at one time, and close the door as soon as possible.

# 3. STRUCTURE AND FUNCTIONS

## 3.1 Key components

(Refrigerating chamber)

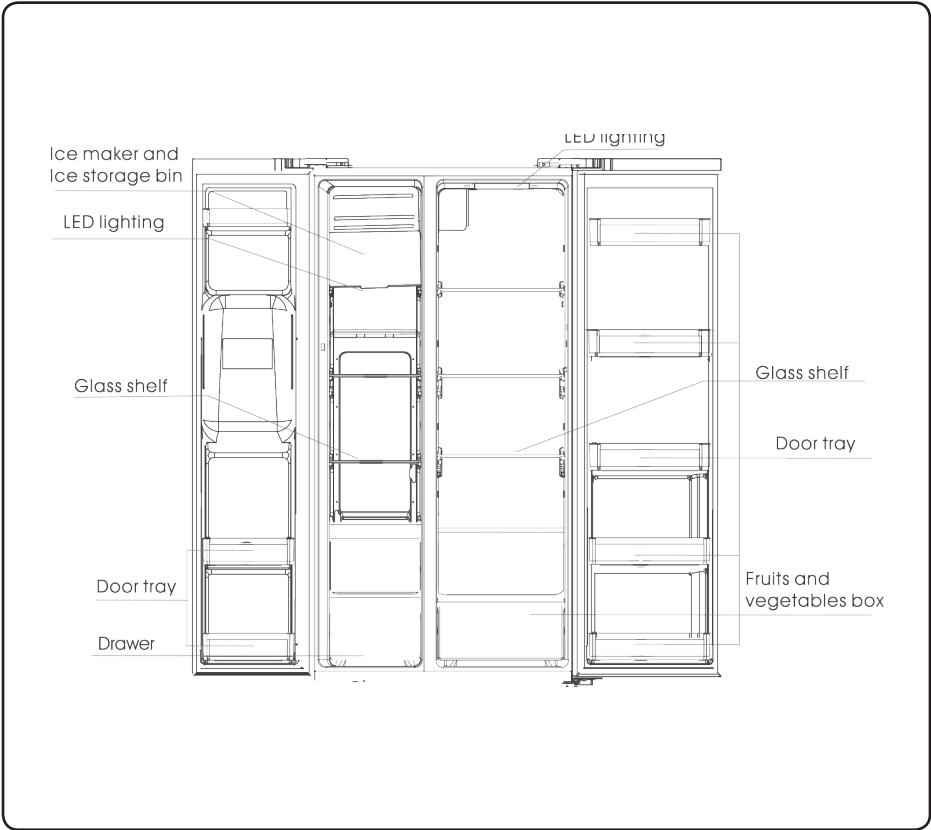

(The picture above is only for reference. The actual configuration will depend on the physical product or statement by the distributor)

### 3.1.1 Refrigerating chamber

- The Refrigerating Chamber is suitable for storage of a variety of fruits, vegetables, beverages and other food consumed in the short term. **Suggested storage time 3 days to 5 days.**
- Cooked or hot food shall not be put in the refrigerating chamber until cooled to room temperature.
- Foods are recommended to be sealed up before putting into the refrigerator.
- The glass shelves can be adjusted up or down for a reasonable amount of storage space and easy use.
- Radar Sensor - Smart Sensor detects temperature and adjust fridge for faster and more accurate cooling, thus keeping freshness and nutrition of food.
- Special **Pt Fresh** technology delivers a healthier and fresher air inside the refrigerator.

**Fresh Zone Drawer** – This drawer is cooler than the rest of the refrigerator ideal for storage of Different cuts of meat and Fish.

**Moisture Drawer** – Selecting between the low or high, this helps fruits and vegetables stored inside to remain crisp, moist and fresh for a longer time. The general guideline is Low Humidity – Primarily Fruit and High Humidity – Primarily Vegetables

**Flex-Zone Drawer** – You are able to adjust the humidity according to what you are placing inside the drawer from Cold Drinks/ Dry Goods or Fruit and Vegetables.

### 3.1.2 Freezing chamber

- The low temperature freezing chamber may keep food fresh for a long time and it is mainly used to store frozen foods and making ice.
- The freezing chamber is suitable for storage of meat, fish, rice balls and other foods not to be consumed in short term.
- Chunks of meat are preferably to be divided into small pieces for quick freezing and easy access.
- Please note that food should be consumed within the shelf time.

**Freeze-Zone Drawer** – this is the quick freezer chamber and items would freeze quicker in this compartment

**Drawers, food boxes, shelves, etc. placed according to the position in the picture above are the most energy efficient.**

**Note:** Storage of too much food during operation after the initial connection to power may adversely affect the freezing effect of the refrigerator. Foods stored shall not block the air outlet; or otherwise the freezing effect will also be adversely affected.

## 3.2 Display Functions

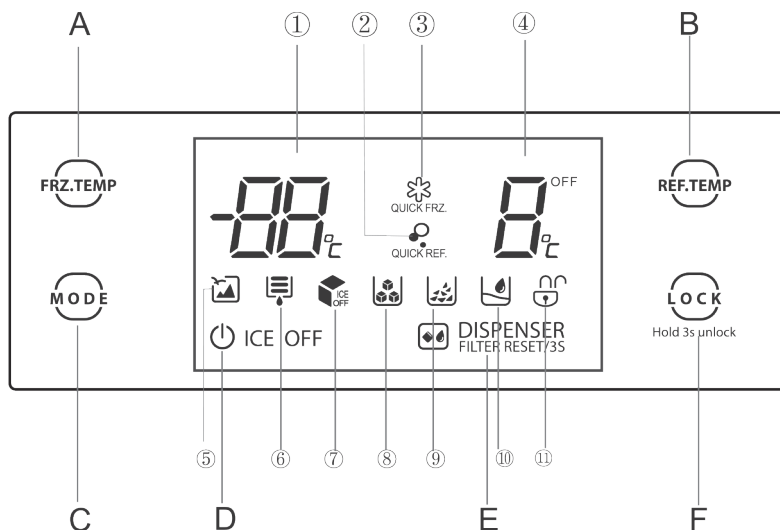

The picture above is only for reference.

### Display

- |  |                      |                        |
|--|----------------------|------------------------|
| ① Freezer compartment temperature      | ② Quick REF.         | ③ Quick FRZ.           |
| ④ Refrigerator compartment temperature | ⑤ Vacation icon      | ⑥ Water filter         |
| ⑦ Ice off                              | ⑧ Fetching ice cubes | ⑨ Fetching crushed ice |
| ⑩ Fetching cold water                  | ⑪ Lock/unlock icon   |                        |

### Button operation

- A.** Freezer compartment temperature adjustment
- B.** Refrigerator compartment temperature adjustment
- C.** Mode setting
- D.** Ice OFF/ON button
- E.** Fetching ice/Fetching water/Filter set
- F.** Lock/Unlock controls

# Operation instructions

## 1) Display

- When you turn on the power to the refrigerator, the display screen will total display for 3 seconds. Meanwhile the starting up bell rings and then the screen enters the normal display of the operation.
- The first time for using the refrigerator, the default set temperature of refrigerating chamber and freezing chamber is 5°C/-18°C respectively.
- When the error occurs, the display shows the error code (see page 15); during normal running, the display shows the set temperature of the refrigerating and freezing compartment.
- Under normal circumstances, if there is no operation on display panel or door opening action within 30s, then the display will lock itself automatically, and be in lock state, the display will go out after 30 seconds

## 2) Lock /unlock

- In the unlocked state, long press the lock button **F** for 3 seconds, enter the lock state, In the locked state, long press the lock button **F** for 3 seconds, enter the unlocked state, All the following functions must be operated in the unlocked state.

## 3) Mode Setting

- Press mode button **C** to select different control mode changing between

## 4) Vacation Mode

- Press mode button **C** to enter the vacation mode. Icon **5** lights up, the vacation mode will take effect after panel locked.
- Press the button **FREEZE TEMP** button **A** or **REF TEMP** button **B** to exit the vacation mode.

## 5) Quick REF Mode

- Press mode button **C** to enter the quick cooling mode Icon **2** lights up, the Quick cooling mode will take effect after panel locked.
- Press the button **REF TEMP** button **B** to exit the quick cooling mode.

## 6) Quick FRZ Mode

- Press mode button **C** to enter the quick-freezing mode Icon **3** lights up, the Quick freezing mode will take effect after panel locked.
- Press the button **FREEZE TEMP** button **A** to exit the quick-freezing mode.

## 7) Temperature setting of refrigerating compartments

- Press temperature adjusting button of the refrigerating compartment **REF TEMP** button **B**, the refrigerating temperature display will blink. Then press **REF TEMP** button **B** again to set the temperature of, and then each time a press of temperature adjusting button of the refrigerating compartment, the temperature will change by 10°C.
- The temperature setting range for refrigerating chamber is 2-8°C.
- After adjusting the temperature, the display will blink for 5 seconds, new temperature will take effect after the display is locked.

## 8) Temperature setting of freezing compartments

- Press temperature adjusting button of the refrigerating compartment **FREEZE TEMP** button **A**, the refrigerating temperature display will blink. Then press **FREEZE TEMP** button **A** again to set the temperature of freezing chamber, and then each time a press of temperature adjusting button of the freezing compartment, the temperature will change by 10°C.
- The temperature setting range for freezing compartment is -24°C~-16°C.
- After adjusting the temperature, the display will blink for 5 seconds, new temperature will take effect after the display is locked.

**Recommended Settings refrigerating compartment 4°C, freezing compartment -18°C**

## 9) Quick-freeze time setting

In quick-freeze mode, long press the **FREEZE TEMP** button **A** for 3 seconds, the refrigerating temperature area will display the existing quick-freeze time, click the **FREEZE TEMP** button **A** again to set the quick-freeze time, the setting circulates as "26-48-26-48 ..", lock the panel or long press the **FREEZE TEMP** button **A** for 3 seconds to exit the quick-freeze time setting. The 48 hours quick-freeze time is mainly for laboratory testing, not recommended for end-consumers.

## 10) Ice Off

- Press the Ice **OFF/ON** button **D** the icon 7 will then light up indicating that the ice maker is off, press the Ice **OFF/ON** button **D** again and the light will turn off indicating that the ice maker is on

## 11) Dispenser

- Press the DISPENSER button **E** to enter the ice/water selection condition; the selection will change the display as shown "Fetching ice cubes / Fetching crushed ice/ Fetching water/ none", and then the corresponding icon on the panel will shine successively.

## 12) Water filter

- When the refrigerator is running, the working time of the water filter will be accumulated; after 150 days, the water filter icon will shine when it reaches 180 days, the water filter icon will blink;
- To reset the filter long press the DISPENSER button E for 3s to reset the service time of water filter.

## 13) Storage upon power failure

- In case of power failure, the instant working state will be memorized and maintained till re-electrification. 1

## 14) Door opening warning

- When the refrigerator chamber door gets open, the warning tone will play. If the door is not closed in two minutes, the buzzer will sound once every second until the door is closed.

## 15) Fault indication

- The following warnings appearing on the display indicate corresponding faults of the refrigerator. Though the refrigerator may still have refrigerator and freezing function with the following faults, the user shall contact SMEG Service center and book a service call for maintenance, so as to ensure normal use of the refrigerator.

ERROR CODE	ERROR DESCRIPTION
<b>E0</b>	Ice-maker error
<b>E1</b>	Temperature sensor detection circuit error of refrigerating chamber
<b>E2</b>	Temperature sensor detection circuit error of freezing chamber
<b>E5</b>	Freezing defrost sensor detection circuit error
<b>E6</b>	Communication error
<b>E7</b>	Circulation of ambient temperature sensor detection circuit error
<b>EE</b>	Ice-maker sensor circuit error
<b>EH</b>	Moisture sensor error

### 3.3 Dispensing Water and Ice

- Sounds will be produced during making ice cubes and crushed ice: Water valve will produce buzzing sounds; water's flowing into ice vessel will produce sounds; grinding machine's grinding ice into small pieces or product ice's falling into the container will produce sounds. The sounds are normal.
- Scratching noises may be produced when taking out the ice cubes. Nothing to worry about this, the sounds are normal.
- The ice in the container may be stuck together. In such cases, please take out the ice container and separate stuck ice into pieces by means of, for instance, using plastic or wooden spoons to push hard on the ice carefully.
- Other possibilities are illustrated in the chapter "ice container cleaning" "To avoid overheating of the ice-making machine's engine, please fetch ice about 1 minute after the stopping. Please wait for a while until the engine's temperature reaches working temperature. Please fetch the ice from the ice container if you need a lot of ice.
- The chapter "ice container cleaning" explains how to remove ice container from freezer compartment.
- If there is no enough ice in the ice container, the ice cannot be taken out. Please wait for a while until new ice is made. To prevent ice smell or bad taste of the ice, please clean the ice container regularly.
- Ice and water can only be fetched when the door of freezer compartment is closed. In the process of fetching water and ice, if you open the freezer door, that process will automatically end.

**Maximum intake pressure 0.8MPa. Minimum intake pressure 0.15MPa**

#### Fetching cold water

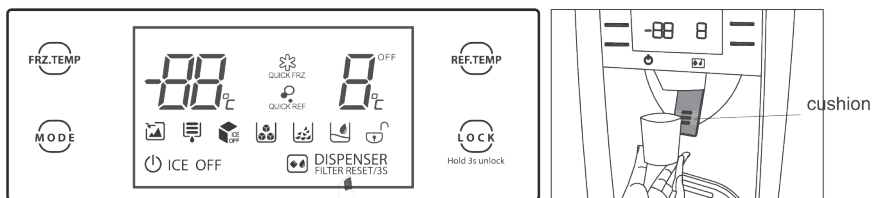

- Push the **DISPENSER** button **E** until the icon **10** turns on.
- Place your container under the dispenser, pushing against the cushion to dispense the water.
- Cold water starts to flow into the container.
- Remove the container from the cushion and the water will stop dispensing.

## Fetching crushed ice

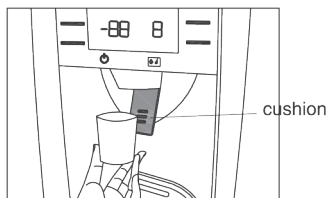
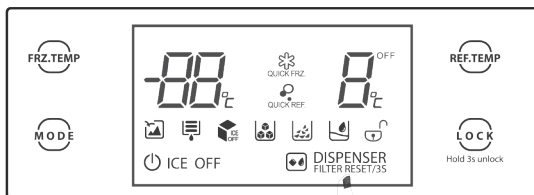

- Push the **DISPENSER** button **E** until the icon **9** turns on.
- Place your container under the dispenser, making sure the container is wide enough for the ice to fall into.
- Fill the Container with crushed ice.
- Remove the container from the cushion and the crushed ice will stop dispensing, wait a few seconds for dispenser to stop before removing the container.

## Fetching ice cubes

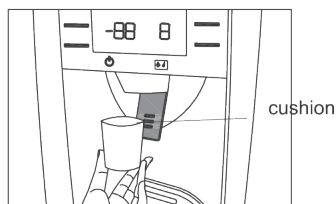
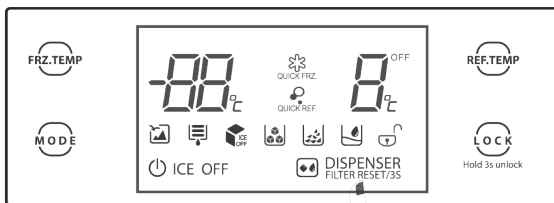

- Push the **DISPENSER** button **E** until the icon **8** turns on.
- Place your container under the dispenser, making sure the container is wide enough for the ice to fall into.
- Fill the Container with ice.
- Remove the container from the cushion and the ice will stop dispensing, wait a few seconds for dispenser to stop before removing the container.

## Cancel the function of ice-making

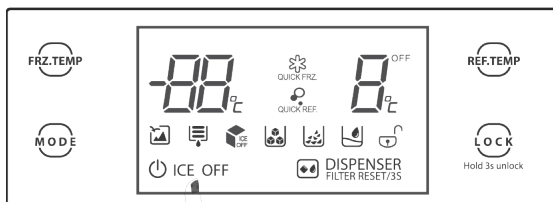

- Should you not be using the **DISPENSER** for a long period of time you can deactivate the function of **ICE MAKING**.
- Push the **ICE OFF** button **D** until the icon **7** turns on, to reactivate the function repeat the first step.



## 4. MAINTENANCE AND CARE OF THE REFRIGERATORS

### 4.1 Overall cleaning

- Please turn off the power before cleaning interior, remove all foods, drinks, shelves, drawers, etc.
- Do not use soap, detergent, scrubbing powder, spray cleaner, abrasive or acidic agents etc. as these may cause odors in the interior of the refrigerator or contaminated food.
- Wipe the outer surface of the refrigerator with a soft cloth dampened with soapy water, detergent, etc., and then wipe dry.
- The interior of the refrigerator should be cleaned regularly to avoid odor.
- Use a soft cloth or sponge to clean the inside of the refrigerator with two tablespoons of baking soda and a quart of warm water. Then rinse with water and wipe clean. After cleaning, open the door and let it dry naturally before turning on the power.
- Check the door gasket regularly to make sure there is no debris. Clean the door gasket with a soft cloth dampened with soapy water or diluted detergent.
- For areas that are difficult to clean in the refrigerator (such as narrow spaces, gaps or corners), it is recommended to wipe them regularly with a soft rag, soft brush, etc. and when necessary, combined with some auxiliary tools (such as thin dial sticks) to ensure no contaminants or bacterial accumulation in these areas.
- Clean the bottle frame, shelves and drawers with a soft cloth dampened with soapy water or diluted detergent. Dry with a soft cloth or dry naturally.
- Do not use hard brushes, wire brushes, abrasives (such as toothpaste), organic solvents (such as alcohol, acetone, banana oil etc), boiling water, acid or alkaline items, which may damage the fridge surface and interior certain products could also deform and damage plastic parts.
- Do not rinse directly with water or other liquids during cleaning to avoid short circuits or affect electrical insulation after immersion.



Please unplug the refrigerator for defrost and cleaning.

## 4.2 Cleaning of door tray

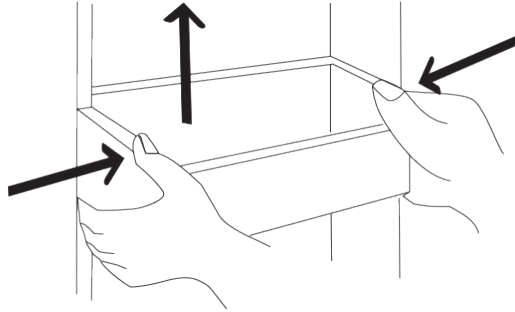

The picture above is only for reference.

- To remove the door tray for cleaning , follow the direction arrow in the figure above, use both hands to squeeze the tray, and push it upward, then you can take it out.
- After washing the tray having been taken out, you can adjust its installing height in accordance with your requirement.

## 4.3 Clean the Ice Container

- Ice in the ice container may block the outlet because of lumping or other reasons. In this case the ice container needs to be check for cleaning or eliminating block.

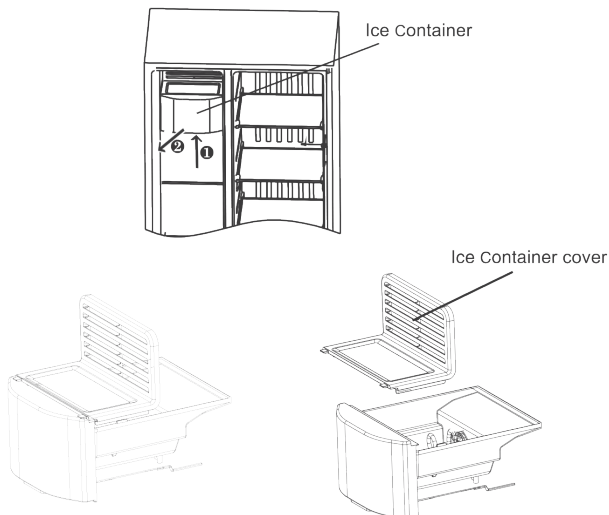

- Push the ICE OFF button **D** until the icon **7** turns on
- Turn off the power to the refrigerator
- Hold the components of the ice storage box with both hands and pull them up and outwards horizontally.
- Dismantle the Ice Container cover from the ice container
- Empty and clean with neutral cleaners (clean cloths and water)
- On completion of cleaning reverse the operation for assembly
- Once all has been completed and items are back in the freezer turn the power back on
- Push the ICE OFF button **D** until the icon **7** turns on

## 4.4 Cleaning of Glass shelves

- As the innermost part of the refrigerator liner where contacting the shelves has a backstop, you need to first raise the shelves upward, then you are able to pull them outward.
- Adjust the height or clean the shelves according to your requirement

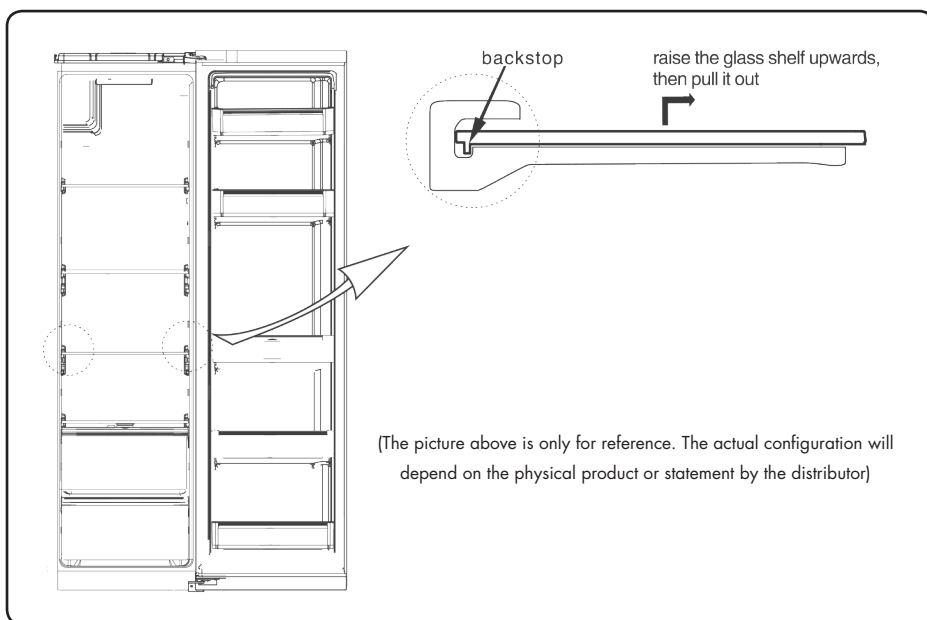

## 4.5 Cleaning of Ice lattice and water pipe

- Ice making function if not used for a period of time, before using again. Please empty the ice in the ice storage box, make half a box of ice (about 24h) and dump it again, then you can use it normally.
- If the water intake function is not used for a period of time, before using again, please press the water intake operation to take two liters of water, and then normal use.

## 4.6 Defrosting

The refrigerator is made based on the air-cooling principle and thus has automatic defrosting function. Frost formed due to change of season or temperature may also be manually removed by disconnection of the appliance from power supply or by wiping with a dry towel

## 4.7 Out of operation

- Power failure: In case of power failure, even if it is in summer foods inside the appliance can be kept for several hours; during the power failure, the times of door opening shall be reduced, and no more fresh food shall be put into the appliance.
- Long-time nonuse: The appliance shall be unplugged and then cleaned; then the doors are left open to prevent odor.

## 4.8 Moving

- Before the refrigerator is moved, take all objects inside out, fix the glass partitions, vegetable holder, freezing chamber drawers and etc. with tape, and tighten the levelling feet; close the doors and fix them with tape.
- During moving, the appliance shall not be laid upside down or horizontally, or be vibrated; the inclination during movement shall be no more than 45°
- At new destination, the refrigerator needs to stand in new location for 4 hours before turning on the powers supply.

## TROUBLE SHOOTING

You may try to solve the following simple problems by yourself.

No Power	Check whether the appliance is connected to power or whether the plug is in well contact
	Check whether the voltage is too low
	Check whether there is a power failure or partial circuits have tripped
Odor	Odorous foods shall be tightly wrapped Check whether there is any rotten food. Clean the inside of the refrigerator
Long-time operation of the compressor	Long operation of the refrigerator is normal in summer when the ambient temperature is high
	It is not suggestible having too much food in the appliance at the same time. Food shall get cool before being put into the appliance
	The doors are opened too frequently
Light fails to get lit	Check whether the refrigerator is connected to power supply and whether the illuminating light is damaged
	Have the light replaced by a specialist
Doors cannot be properly closed	The door is stuck by food packages Too much food is placed
	The refrigerator is tilted
Loud noise	Check whether the floor is level and whether the refrigerator is placed stably. Check whether accessories are placed at proper locations
Door seal fails to be tight	Remove foreign matters on the door seal
Water pan overflows	There is too much food in the chamber or food stored contains too much water. Resulting in heavy defrosting
	The doors are not closed properly, resulting in frosting due to entry of air and increased water due to defrosting
Hot housing	Heat dissipation of the built-in condenser via the housing, which is normal When housing becomes hot due to high ambient temperature, storage of too much food or shutdown of the compressor is shut down, provide sound ventilation to facilitate heat dissipation
Surface condensation	Condensation on the exterior surface and door seals of the refrigerator is normal when the ambient humidity is too high. Just wipe the condensate with a clean towel.
Abnormal noise	Buzz: The compressor may produce buzzes during operation, and the buzzes are loud particularly upon start or stop. This is normal.
	Creak: Refrigerant flowing inside of the appliance may produce creak, which is normal.

**Climate classes**

This refrigerating appliance is intended to be used in the ambient temperatures shown below

Class	Symbol	Ambient temperature range
Extended temperate	SN	+10° to +32°
Temperate	N	+16° to +32°
Subtropical	ST	+16° to +38°
Tropical	T	+16° to +43°

## **SERVICE CENTRE CONTACT INFORMATION**

Website

**[www.smeg.co.za](http://www.smeg.co.za)**

Email address

**[service@smegsa.co.za](mailto:service@smegsa.co.za)**

Contact number

**011-656-0025**



