

FAQ

1 - Change the cartridge/knob

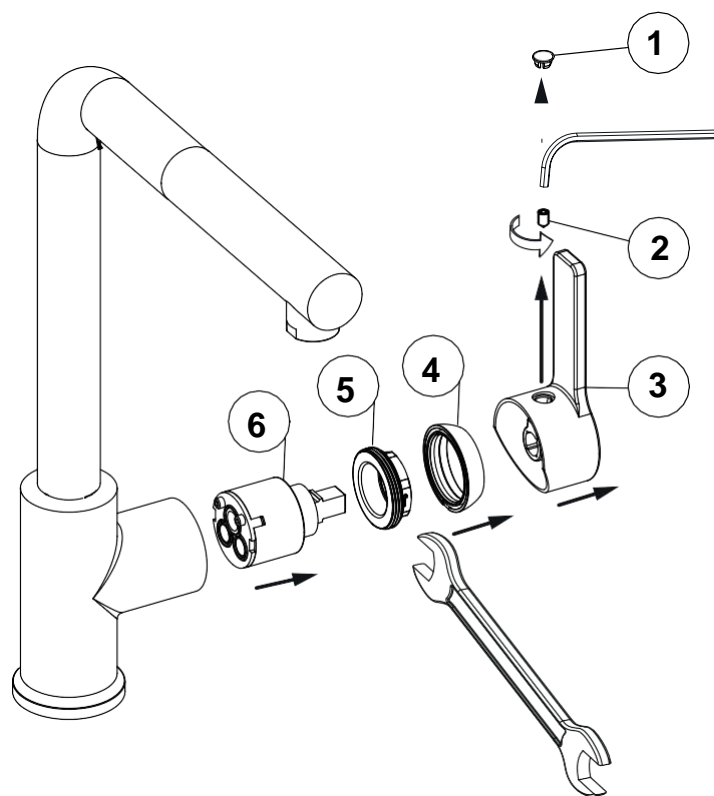

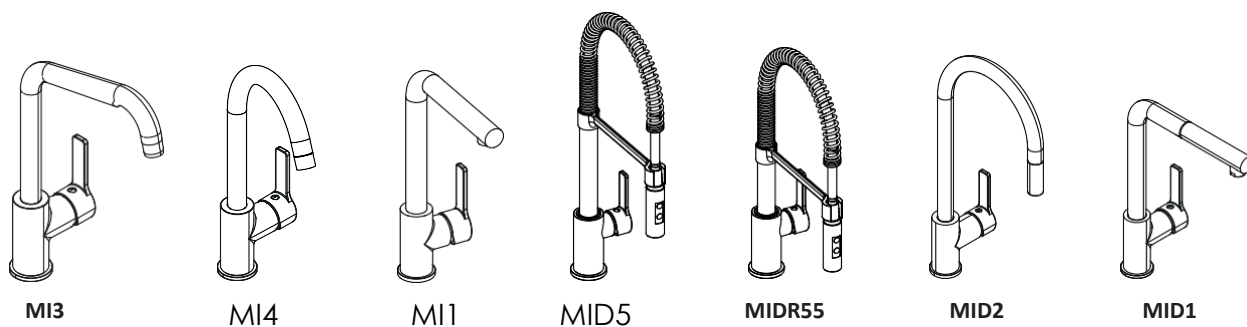
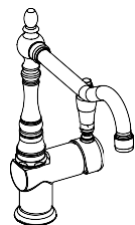

MIR6



MICOR9

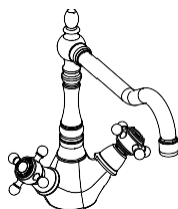
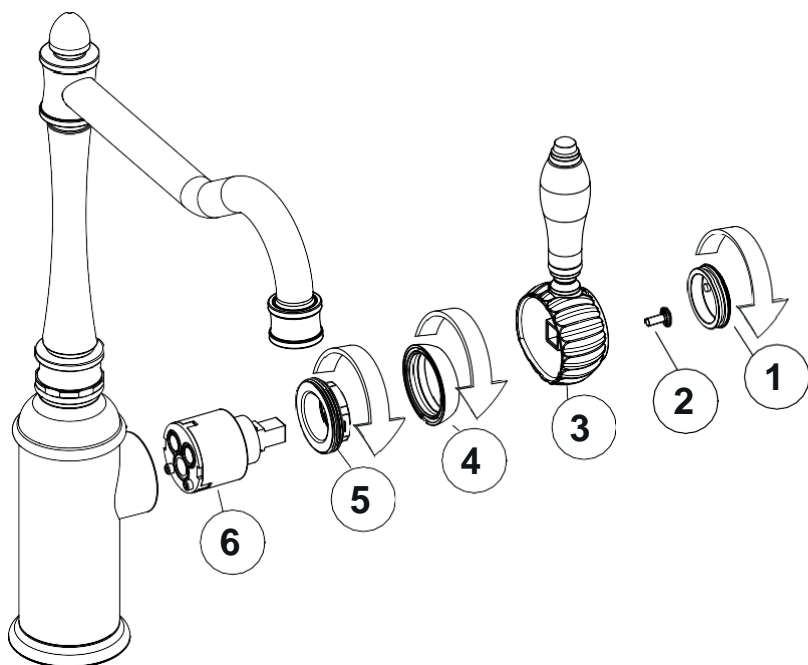

MIR8

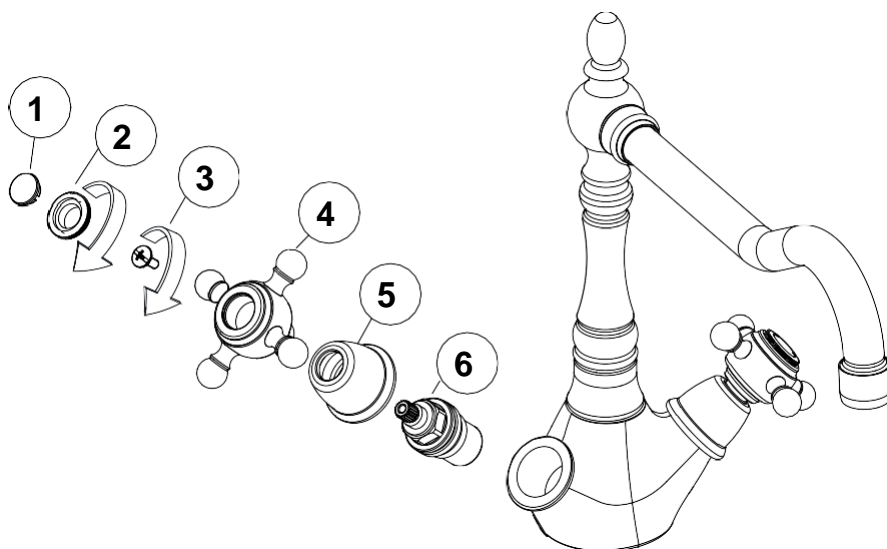

2 - Cleaning products that can be used without damaging the mixer's finishing



- only use products with a neutral pH value specifically supplied for this type of use;
- never use cleaning materials containing hydrochloric acid, formic acid, chlorine bleach or acetic acid, as they cause considerable damage;
- acid phosphorus detergents can be applied only under certain conditions;
- mixing of different detergents is generally not permitted;
- never use cleaning materials or equipment with an abrasive effect, such as inappropriate cleaning powders, sponges or microfibre cloths;
- the instructions of the detergent manufacturers must be followed carefully;
- cleaning must be carried out with a specific dose of detergent, for an appropriate limited time, related to the objects and adapted to the needs;
- scale must be removed by regular cleaning;
- when using spray cleaners, spray the cleaning solution onto a soft cloth or sponge, never directly onto the products, as the spray may enter openings and gaps in the product and cause damage;
- after cleaning, rinse thoroughly with clean water to remove any residual detergent;
- the use of steam cleaners is not permitted. High temperatures can damage the products.

3 - Is there a leak in the mixer?

SOLUTION:

Check whether the leak is at the base of the part (**SOLUTION A**) or under the lever (**SOLUTION B**)

SOLUTION A:

Replacement of hoses:

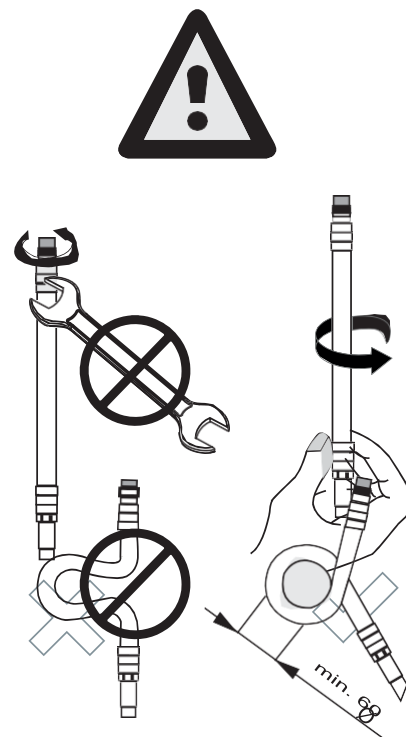
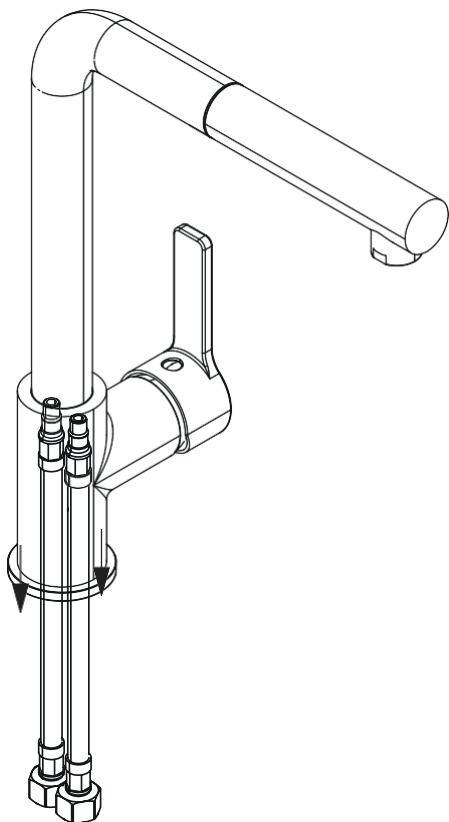

SOLUTION B:

Replacing the cartridge (**SEE POINT 1**)

4 - Change the aerator or pull-out spray

Our mixers do not require any particular maintenance, except for periodic cleaning of the aerator, which collects debris and scale on the internal screen, causing a gradual loss of flow over time. To clean the aerator screen, proceed as follows: unscrew the aerator by turning it counter-clockwise. Remove impurities from the filter screen by using running water and/or soaking it in vinegar to dissolve scale (do not immerse chrome-plated or finished parts). Reassemble, checking that the seal is correctly positioned.

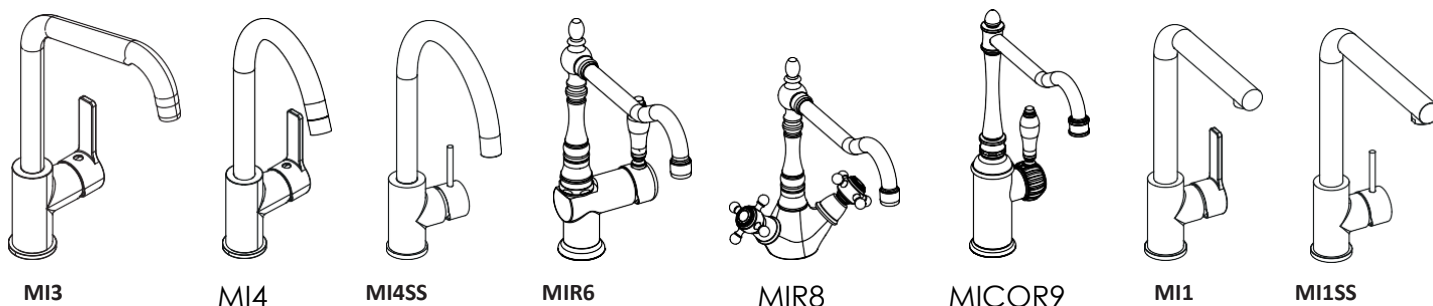

REPLACEMENT OF STANDARD AERATOR:

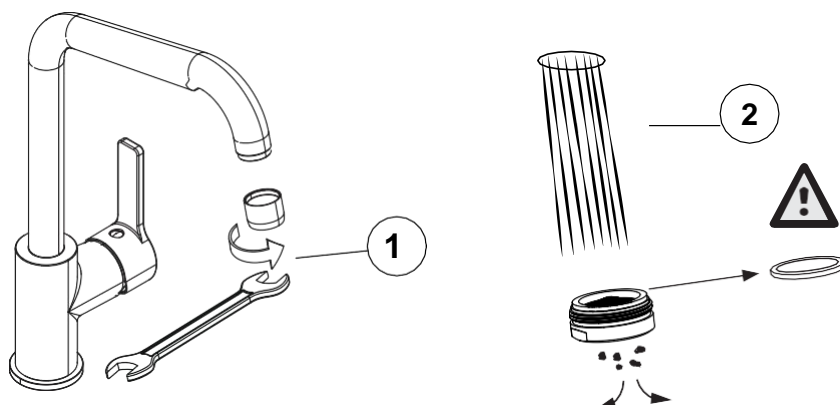

REPLACEMENT OF COIN SLOT AERATOR:

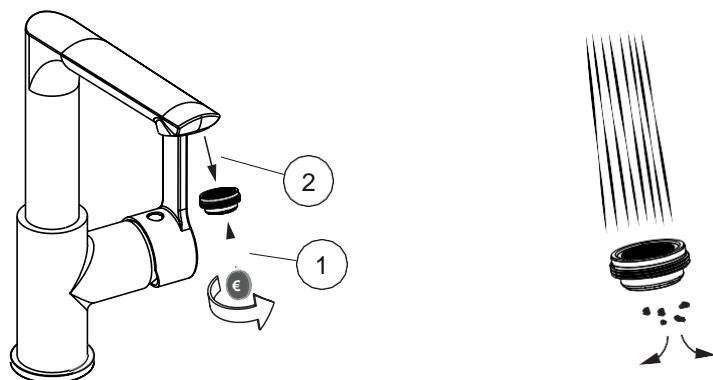

REPLACEMENT OF PULL-OUT SPRAY HEAD:

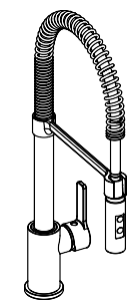

MID5

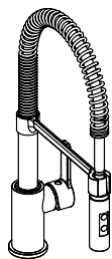

MIDR55

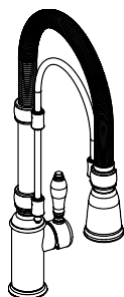

MIDR7

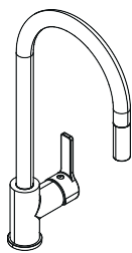

MID2

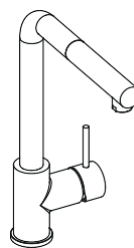

MID1SS

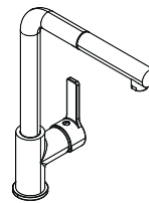

MID1

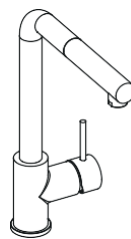

MID1SS

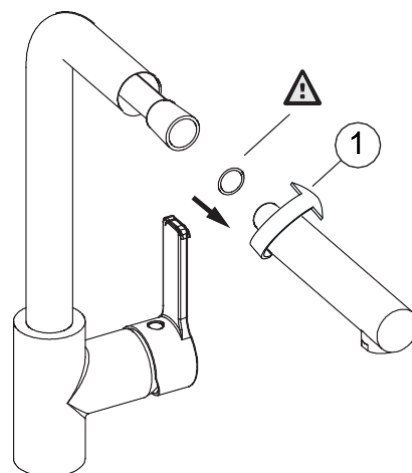
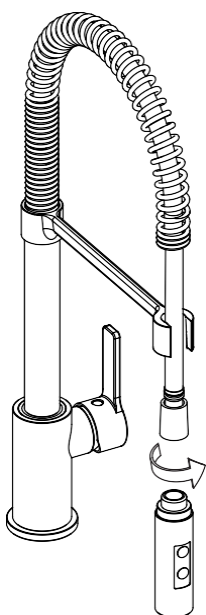

5 - Water flow is reduced even when the lever is fully open Check that there is no dirt inside the aerator filter. Remove the aerator and proceed with cleaning (**SEE POINT 4**)

6 - Lever is hard during opening/closing

A possible build-up of scale blocks the movement. You need to change the cartridge (**SEE POINT 1**)