

Libretto d' uso

User manual

Manuel d'utilisation

Gebrauchsanleitung

Gebruiksaanwijzing

Manual de uso

Livro para utilização

Brugsvejledning

Användningshandbok

Руководство по эксплуатации

Instrukcja użytkowania

Bruksveiledning

كتيب الاستعمال

KSEG120XE - KSEG90XE
KSEG90VXNE - KSEG90VXBE

INDICE

IT

CONSIGLI E SUGGERIMENTI.....	5
CARATTERISTICHE.....	6
INSTALLAZIONE.....	7
USO.....	8
MANUTENZIONE.....	10

INDEX

EN

RECOMMENDATIONS AND SUGGESTIONS.....	12
CHARACTERISTICS.....	13
INSTALLATION.....	14
USE.....	15
MAINTENANCE.....	17

SOMMAIRE

FR

CONSEILS ET SUGGESTIONS.....	19
CARACTERISTIQUES.....	20
INSTALLATION.....	21
UTILISATION.....	22
ENTRETIEN.....	24

INHALTSVERZEICHNIS

DE

EMPFEHLUNGEN UND HINWEISE.....	26
CHARAKTERISTIKEN.....	27
MONTAGE.....	28
BEDIENUNG.....	29
WARTUNG.....	31

INHOUDSOPGAVE

NL

ADVIEZEN EN SUGGESTIES.....	33
EIGENSCHAPPEN.....	34
INSTALLATIE.....	35
GEbruik.....	36
ONDERHOUD.....	38

ÍNDICE

ES

CONSEJOS Y SUGERENCIAS.....	40
CARACTERÍSTICAS.....	41
INSTALACIÓN.....	42
USO.....	43
MANTENIMIENTO.....	45

ÍNDICE

PT

CONSELHOS E SUGESTÕES.....	47
CARACTERÍSTICAS	48
INSTALAÇÃO.....	49
UTILIZAÇÃO	50
MANUTENÇÃO.....	52

INDHOLD

DK

RÅD OG ANVISNINGER	54
APPARATBESKRIVELSE	55
INSTALLATION.....	56
BRUG	57
VEDLIGEHOLDELSE	59

INNHOOLD

NO

ANBEFALINGER OG FORSLAG	61
EGENSKAPER.....	62
INSTALLASJON.....	63
BRUK	64
VEDLIKEHOLD	66

УКАЗАТЕЛЬ

RU

СОВЕТЫ И РЕКОМЕНДАЦИИ	68
ХАРАКТЕРИСТИКИ.....	69
УСТАНОВКА.....	70
ЭКСПЛУАТАЦИЯ.....	71
УХОД.....	73

SPIS TREŚCI

PL

UWAGI I SUGESTIE.....	75
WŁAŚCIWOŚCI TECHNICZNE.....	76
INSTALACJA.....	77
UŻYTKOWANIE.....	78
KONSERWACJA	80

INNEHÅLL

SE

REKOMMENDATIONER OCH TIPS	82
EGENSKAPER.....	83
INSTALLATION.....	84
ANVÄNDING	85
UNDERHÅLL.....	87

الفهرس

اقتراحات و ارشادات.....	89
نص الخصا.....	90
التركيب.....	91
الاستخدام.....	92
عملية الصيانة.....	94

RECOMMENDATIONS AND SUGGESTIONS

⚠ The Instructions for Use apply to several versions of this appliance. Accordingly, you may find descriptions of individual features that do not apply to your specific appliance.

INSTALLATION

- The manufacturer will not be held liable for any damages resulting from incorrect or improper installation.
- The minimum safety distance between the cooker top and the extractor hood is 650 mm (some models can be installed at a lower height, please refer to the paragraphs on working dimensions and installation).
- Check that the mains voltage corresponds to that indicated on the rating plate fixed to the inside of the hood.
- For Class I appliances, check that the domestic power supply guarantees adequate earthing. Connect the extractor to the exhaust flue through a pipe of minimum diameter 120 mm. The route of the flue must be as short as possible.
- Do not connect the extractor hood to exhaust ducts carrying combustion fumes (boilers, fireplaces, etc.).
- If the extractor is used in conjunction with non-electrical appliances (e.g. gas burning appliances), a sufficient degree of aeration must be guaranteed in the room in order to prevent the backflow of exhaust gas. The kitchen must have an opening communicating directly with the open air in order to guarantee the entry of clean air. When the cooker hood is used in conjunction with appliances supplied with energy other than electric, the negative pressure in the room must not exceed 0,04 mbar to prevent fumes being drawn back into the room by the cooker hood.
- In the event of damage to the power cable, it must be replaced by the manufacturer or by the technical service department, in order to prevent any risks.
- If the instructions for installation for the gas hob specify a greater distance specified above, this has to be taken into account. Regulations concerning the discharge of air have to be fulfilled.

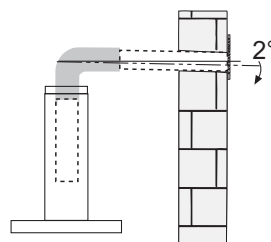
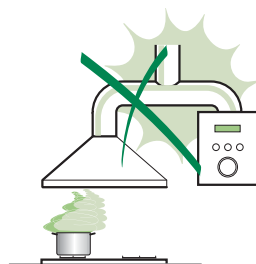

USE

- The extractor hood has been designed exclusively for domestic use to eliminate kitchen smells.
- Never use the hood for purposes other than for which it has been designed.
- Never leave high naked flames under the hood when it is in operation.
- Adjust the flame intensity to direct it onto the bottom of the pan only, making sure that it does not engulf the sides.
- Deep fat fryers must be continuously monitored during use: overheated oil can burst into flames.
- Do not flambé under the range hood; risk of fire
- This appliance is not intended for use by persons (including children) with reduced physical, sensory or mental capabilities, or lack of experience and knowledge, unless they have been given supervision or instruction concerning use of the appliance by a person responsible for their safety.
- Children should be supervised to ensure that they do not play with the appliance.
- "CAUTION: Accessible parts may become hot when used with cooking appliances."

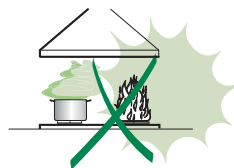

MAINTENANCE

- Switch off or unplug the appliance from the mains supply before carrying out any maintenance work.
- Clean and/or replace the Filters after the specified time period (Fire hazard).
- Clean the hood using a damp cloth and a neutral liquid detergent.

The symbol  on the product or on its packaging indicates that this product may not be treated as household waste. Instead it shall be handed over to the applicable collection point for the recycling of electrical and electronic equipment. By ensuring this product is disposed of correctly, you will help prevent potential negative consequences for the environment and human health, which could otherwise be caused by inappropriate waste handling of this product. For more detailed information about recycling of this product, please contact your local city office, your household waste disposal service or the shop where you purchased the product.

CHARACTERISTICS

Dimensions

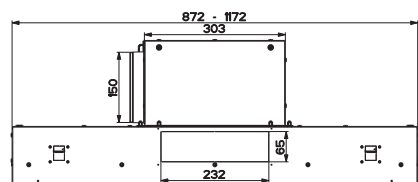
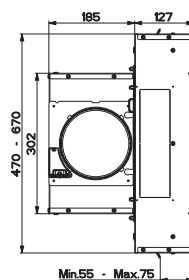
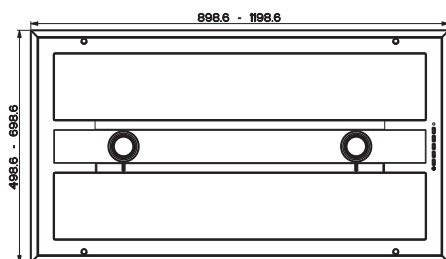
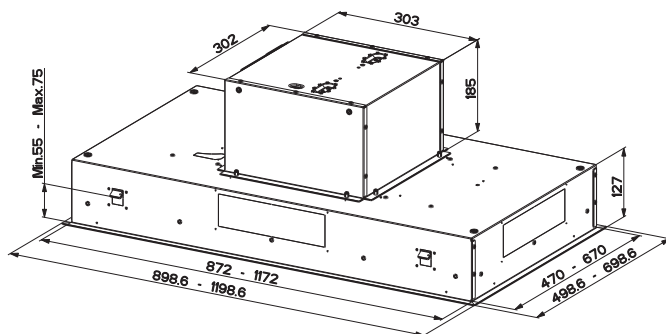

INSTALLATION

Fixing the Hood

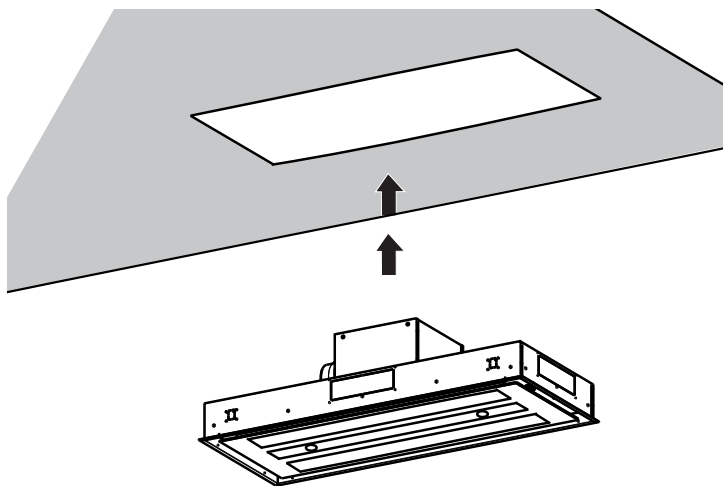

- In all cases where the ceiling is not strong enough at the suspension point, the installer must provide strengthening using suitable plates and backing pieces anchored to the structurally sound parts.

ELECTRICAL CONNECTION

- Connect the hood to the mains through a two-pole switch having a contact gap of at least 3 mm.

Control panel

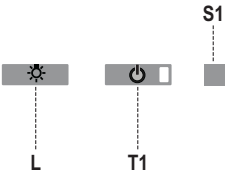

Button	Function	Led
L	Turns the lights ON/OFF at maximum intensity.	-
	Press and hold the button for approximately 4 seconds, with all the loads turned off (Motor and Lights), to turn the Activated Charcoal Filter alarm on/off.	LED S1 flashes twice = alarm ON. LED S1 flashes once = alarm OFF.
T1	Turns the motor on/off at speed one.	-
	Press and hold the button for approximately 2 seconds, with all the loads turned off (Motor and Lights), to reset the Activated Charcoal Filter alarm.	LED S1 turns OFF (Fixed or Flashing).
S1	Signals the Metal Grease Filter saturation alarm, indicating that it is necessary to wash the filters. The alarm is triggered after the Hood has been in operation for 100 working hours.	Fixed
	When this is activated, it signals the Activated Charcoal Filter saturation alarm, indicating that the filter must be changed; the Metal Grease Filters must also be washed. The Activated Charcoal Filter saturation alarm comes into operation after the Hood has been working for 200 hours.	Flashing

REMOTE CONTROL

The appliance can be controlled using a remote control powered by a 1.5 V carbon-zinc alkaline batteries of the standard LR03-AAA type (not included).

- Do not place the remote control near to heat sources.
- Used batteries must be disposed of in the proper manner.

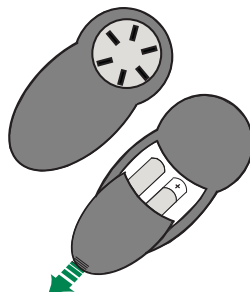

Control panel



Button	Function	Display
	Turns the Motor On/Off.	-
	Decreases the speed of the Motor.	-
	Increases the speed of the Motor.	-
	INTENSIVE <ul style="list-style-type: none"> - Activates Intensive speed from any other speed. - To disable it, simply press the same button again or turn the motor off. - Intensive speed is timed to run for 10 minutes. At the end of the 10 minutes the system automatically returns to the speed set previously. 	-
	Press briefly for the Delay Function: Can only be activated if the Intensive or 24h function is not active. Activates and deactivates total shutdown of the hood (motor+lights) after 30 minutes: To disable the Delay, simply press the button again or turn the motor off.	The led on the motor button (on the hood controls) will flash once every 0.5 seconds.
	Press and hold for 2sec for the 24H Function: Can only be activated if the Intensive or Delay function is not active. Activates and deactivates the 24H function for 10 minutes every hour, for 24 hours. After this time it is deactivated.	The led on the motor button (on the hood controls) will flash once every 2 seconds.
	Turns the Hood lights On/Off at maximum intensity.	-
	Press and hold for 2sec to turn the Hood lights On/Off at reduced intensity.	-

MAINTENANCE

Opening Panel

- Open the Panel by pulling it.
- Clean the outside with a damp cloth and neutral detergent.
- Clean the inside using a damp cloth and neutral detergent; do not use wet cloths or sponges, or jets of water; do not use abrasive substances.

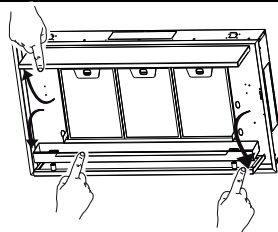

Grease filters

CLEANING METAL SELF- SUPPORTING GREASE FILTERS

- The filters must be cleaned every 2 months of operation, or more frequently for particularly heavy usage, and can be washed in a dishwasher.
- Pull the comfort panels to open them.
- Remove the filters one by one pushing them towards the back side of the hood unit and simultaneously pulling downwards.
- Any kind of bending of the filters has to be avoided when washing them. Before fitting them again into the hood make sure that they are completely dry. (The colour of the filter surface may change throughout the time but this has no influence to the filter efficiency).
- When fitting the filters into the hood pay attention that they are mounted in correct position the handle facing outwards.
- Close the comfort panel.

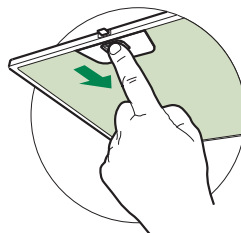

Activated charcoal filter (Recirculation version)

These filters are not washable and cannot be regenerated, and must be replaced approximately every 4 months of operation, or more frequently with heavy usage.

REPLACING THE ACTIVATED CHARCOAL FILTER

- Open the comfort panels pulling them downwards.
- Remove the metal grease filters
- Remove the saturated activated charcoal filter as shown (A).
- Fit the new filters (B).
- Replace the metal grease filters.
- Close the comfort panels.

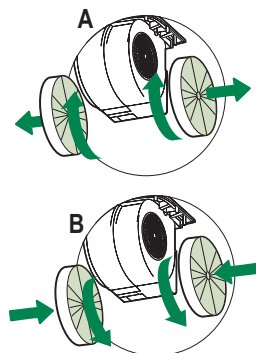

Lighting unit

Warning: This appliance is fitted with a white LED lamp classed as 1M according to EN 60825-1: 1994 + A1:2002 + A2:2001 standards; maximum optical power emitted @439nm: 7μW. Do not look directly at the light through optical devices (binoculars, magnifying glasses...).

- For replacement contact technical support. ("To purchase contact technical support")