



**ELECTRONIC  
NO-FROST COMBI REFRIGERATOR**  
Instruction booklet

**FRIGORIFERO  
COMBINATO NO FROST**  
Guida all'installazione e uso

**ELEKTRONISCHE NO-FROST  
KÜHL-GEFRIERKOMBI**  
Bedienungsanleitung

**RÉFRIGÉRATEUR  
COMBI NO-FROST ÉLECTRONIQUE**  
Notice d'installation et d'utilisation

**ELEKTRONISKT NO FROST COMBI KYLSKÅP  
FRYS - KYLSKÅP**  
Bruksanvisning

**ELEKTRONISK FROSTFRI KOMBIKJØLESKAP  
FRYSER - KJØLESKAP**  
Bruksanvisning

**FC40PXNE4  
FC40MNE4**



# Contents

<b>BEFORE USING THE APPLIANCE .....</b>	<b>2</b>
General warnings .....	2
Old and out-of-order fridges or freezers .....	4
Safety warnings .....	4
Installing and operating your fridge .....	5
Before using your fridge freezer .....	6
Information on No-Frost technology .....	6
<b>USAGE INFORMATION.....</b>	<b>7</b>
Display and control panel .....	7
Operating your fridge.....	8
Super freeze mode .....	8
Super cool mode.....	8
Economy mode .....	8
Holliday mode .....	9
Drink cool mode.....	9
Screen saver mode.....	10
Light cancelling mode .....	10
Function of Child lock.....	10
Cooler temperature settings .....	11
Freezer temperature settings .....	11
Warnings about temperature adjustments.....	11
Accessories .....	12
Ice box .....	12
Freezer box.....	12
Odor filter .....	12
Roller storage box.....	12
Fresh dial .....	13
Ice pack.....	13
<b>ARRANGING FOOD IN THE APPLIANCE .....</b>	<b>14</b>
Refrigerator compartment.....	14
Deep freezer compartment.....	14
<b>CLEANING AND MAINTENANCE .....</b>	<b>15</b>
Defrosting .....	15
<b>TRANSPORTATION AND CHANGING OF INSTALLATION POSITION .....</b>	<b>16</b>
Repositioning the door.....	16
<b>BEFORE CALLING YOUR AFTER SALES SERVICE.....</b>	<b>17</b>
Tips for saving energy .....	19
<b>THE PARTS OF THE APPLIANCE AND THE COMPARTMENTS .....</b>	<b>20</b>

### **General warnings**

**WARNING:** Keep ventilation openings, in the appliance enclosure or in the built-in structure, clear of obstruction.

**WARNING:** Do not use mechanical devices or other means to accelerate the defrosting process, other than those recommended by the manufacturer.

**WARNING:** Do not use electrical appliances inside the food storage compartments of the appliance, unless they are of the type recommended by the manufacturer.

**WARNING:** Do not damage the refrigerant circuit.

**WARNING:** In order to avoid any hazards resulting from the instability of the appliance, it must be fixed in accordance with the following instructions:

- If your appliance uses R600a as a refrigerant (this information will be provided on the label of the cooler) you should take care during transportation and installation to prevent the cooler elements from being damaged. R600a is an environmentally friendly and natural gas, but it is explosive. In the event of a leak due to damage of the cooler elements, move your fridge away from open flames or heat sources and ventilate the room where the appliance is located for a few minutes.
- While carrying and positioning the fridge, do not damage the cooler gas circuit.
- Do not store explosive substances such as aerosol cans with a flammable propellant in this appliance.
- This appliance is intended to be used in household and domestic applications such as:
  - staff kitchen areas in shops, offices and other working environments.

- farm houses and by clients in hotels, motels and other residential type environments.
- bed and breakfast type environments;
- catering and similar non-retail applications.
- If the socket does not match the refrigerator plug, it must be replaced by the manufacturer, a service agent or similarly qualified persons in order to avoid a hazard.
- A specially grounded plug has been connected to the power cable of your refrigerator. This plug should be used with a specially grounded socket of 16 amperes. If there is no such socket in your house, please have one installed by an authorised electrician.
- This appliance can be used by children aged from 8 years and above and persons with reduced physical, sensory or mental capabilities or lack of experience and knowledge if they have been given supervision or instruction concerning use of the appliance in a safe way and understand the hazards involved. Children shall not play with the appliance. Cleaning and user maintenance shall not be made by children without supervision.
- If the supply cord is damaged, it must be replaced by the manufacturer, an authorised service agent or similar qualified persons, in order to avoid a hazard.
- This appliance is not intended for use at altitudes exceeding 2000 m.

## Old and out-of-order fridges or freezers

- If your old fridge has a lock, break or remove the lock before discarding it, because children may get trapped inside it and may cause an accident.
- Old fridges and freezers may contain isolation material and refrigerant with CFC or HFC. Therefore, take care not to harm environment when you are discarding your old fridges..

### Disposal of your old appliance

This symbol on the product or package implies that the product should not be treated as domestic waste. Instead, it should be delivered to applicable waste collection places recycling electrical and electronic equipment. You will contribute to avoid potential negative results regarding environment and human health, which will arise due to wrong waste procedure for the product by ensuring that this product is annihilated properly. Recycling materials will help natural resources be preserved. For more detailed information regarding recycling of this product, please contact local municipality, domestic waste annihilation service or the shop you have purchased the product.

Please ask your municipal authority about the disposal of the WEEE for the reuse, recycle and recovery purposes.

#### Notes:

- Please read the instruction manual carefully before installing and using your appliance.  
**We are not responsible for the damage occurred due to misuse.**
- Follow all instructions on your appliance and instruction manual, and keep this manual in a safe place to resolve the problems that may occur in the future.
- This appliance is produced to be used in homes and it can only be used in domestic environments and for the specified purposes. It is not suitable for commercial or common use. Such use will cause the guarantee of the appliance to be cancelled and our company will not be responsible for losses incurred.
- This appliance is produced to be used in houses and it is only suitable for cooling / storing food. It is not suitable for commercial or common use and/or for storing substances except for food. Our company is not responsible for losses to be incurred in the contrary case.

### Safety warnings

- Do not connect your Fridge Freezer to the mains electricity supply using an extension lead.
- Do not plug in damaged, torn or old plugs.
- Do not pull, bend or damage the cord.



- This appliance is designed for use by adults, do not allow children to play with the appliance or let them hang off the door.
- Never touch the power cord/plug with wet hands as this could cause a short circuit or electric shock.

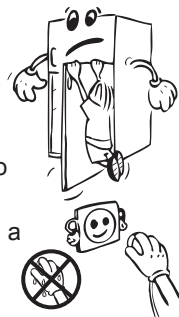

- Do not place glass bottles or beverage cans in the ice-making compartment as they can burst as the contents freeze.
- Do not place explosive or flammable material in your fridge. Place drinks with high alcohol content vertically in the fridge compartment and make sure that their tops are tightly closed.
- When removing ice from the ice-making compartment, do not touch it. Ice may cause frost burns and/or cuts.
- Do not touch frozen goods with wet hands. Do not eat ice-cream or ice cubes immediately after you have taken them out of the ice-making compartment.
- Do not re-freeze frozen goods after they have melted. This may cause health issues such as food poisoning.
- Do not cover the body or top of fridge with lace. This affects the performance of your fridge.
- Secure any accessories in the fridge during transportation to prevent damage to the accessories.



## Installing and operating your fridge

*Before using your fridge, you should pay attention to the following points:*

- The operating voltage for your fridge is 220-240 V at 50Hz.
- The mains cord of your fridge is fitted with a grounded plug. This plug should be used with a grounded receptacle that has a 16 ampere fuse minimum. If you don't have a receptacle which conforms to this, contact a qualified electrician.
- We do not accept responsibility for any damages that occur due to ungrounded usage.
- Place your fridge where it will not be exposed to direct sunlight.
- Your appliance should be at least 50 cm away from stoves, gas ovens and heater cores, and at least 5 cm away from electrical ovens.
- Your fridge should never be used outdoors or exposed to rain.
- When your fridge is placed next to a deep freezer, there should be at least 2 cm between them to prevent humidity forming on the outer surface.
- Do not place anything on your fridge, and install your fridge in a suitable place so that at least 15 cm of free space is available above it.
- Use the adjustable front legs to make sure your appliance is level and stable. You can adjust the legs by turning them in either direction. This should be done before placing food in the fridge.
- Before using your fridge, wipe all parts with a solution of warm water and a teaspoon of sodium bicarbonate, then rinse with clean water and dry. Place all parts in the fridge after cleaning.
- Install the plastic distance guide (the part with black vanes at the rear) by turning it 90° (as shown in the figure) to prevent the condenser from touching the wall.
- The refrigerator should be placed against a wall with a free space not exceeding 75 mm.

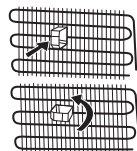

## Before using your fridge freezer

- When using your fridge for the first time, or after transportation, keep it in an upright position for at least 3 hours before plugging into the mains. This allows efficient operation and prevents damage to the compressor.
- Your fridge may have a smell when it is operated for the first time. This is normal and the smell will fade away when your fridge starts to cool.

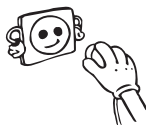

## Information on No-Frost technology

No-frost refrigerators differ from other static refrigerators in their operating principle.

In normal fridges, the humidity entering the fridge due to opening the door and the humidity inherent in the food causes freezing in the freezer compartment. To defrost the frost and ice in the freezer compartment, you are periodically required to turn off the fridge, place the food that needs to be kept frozen in a separately cooled container and remove the ice gathered in the freezer compartment.

The situation is completely different in no-frost fridges. Dry and cold air is blown into the fridge and freezer compartments homogeneously and evenly from several points via a blower fan. Cold air dispersed homogeneously and evenly between the shelves cools all of your food equally and uniformly, thus preventing humidity and freezing.

Therefore your no-frost fridge allows you ease of use, in addition to its huge capacity and stylish appearance.

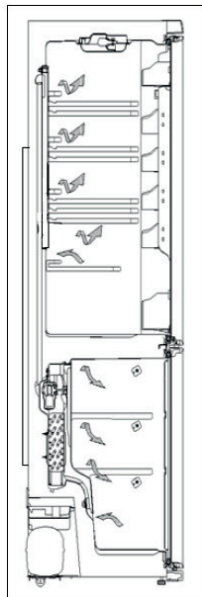



## PART - 1. USAGE INFORMATION

### Display and control panel

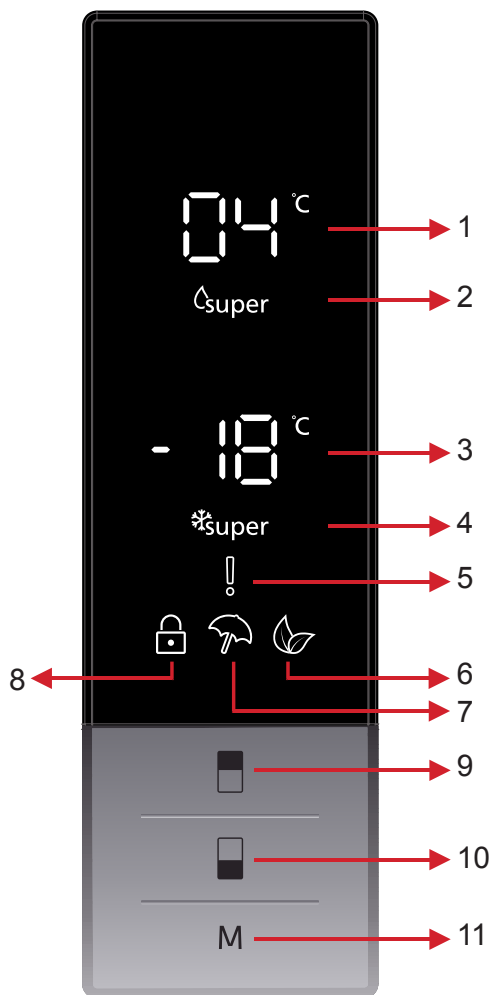

#### Use of control panel

1. It is cooler set value screen.
2. It is super cooling indicator.
3. It is freezer set value screen.
4. It is super freeze indicator.
5. It is alarm symbol.
6. It is economy mode symbol.
7. It is holiday mode symbol.
8. It is child-lock symbol.
9. It enables the setting value of cooler to be modified and super cool mode to be activated if desired. Cooler may be set to 8, 6, 5, 4, 2 °C super cool.
10. It enables the setting value of freezer to be modified and super freeze mode to be activated if desired. Freezer may be set to -16, -18, -20, -22, -24 °C super freeze.
11. It enables the modes (economy, holiday...) to be activated if desired.

## Operating your fridge

### Super freeze mode

#### How would it be used?

- Press freezer set button until Super freeze symbol will be seen on the screen. Buzzer will sound beep beep. Mode will be set.

#### During this mode:

- Temperature of cooler and super cool mode may be adjusted. In this case super freeze mode continues.
- Economy and Holiday mode can not be selected.
- Super freeze mode can be cancelled by the same operation of selecting.



### Super cool mode

#### How would it be used?

- Press cooler set button until Super cool symbol will be seen on the screen. Buzzer will sound beep beep. Mode will be set.

#### During this mode:

- Temperature of freezer and super freeze mode may be adjusted. In this case super cool mode continues.
- Economy and Holiday mode can not be selected.
- Super cool mode can be cancelled by the same operation of selecting.



### Economy mode

#### How would it be used?

- Push "mode button" until eco symbol appears.
- If no button is pressed for 1 second. Mode will be set. Eco symbol will blink 3 times. When mode is set, buzzer will sound beep beep.
- Freezer and refrigerator temperature segments will show "E".
- Economy symbol and E will light till mode finishes.

#### During this mode:

- Freezer may be adjusted. When economy mode will be cancelled, the selected setting values will proceed.
- Cooler may be adjusted. When economy mode will be cancelled, the selected setting values will proceed.
- Super cool and super freeze modes can be selected. Economy mode is automatically cancelled and the selected mode is activated.
- Holiday mode can be selected after cancelling the economy mode. Then the selected mode is activated.
- To cancel, you will just need to press on mode button.



## Holliday mode

### How would it be used?

- Push "mode button" until holiday symbol appears
- If no button is pressed for 1 second. Mode will be set. Holiday symbol will blink 3 times. When mode is set, buzzer will sound beep beep.
- Cooler temperature segment will show "--".
- Holiday symbol and "--" will light till mode finishes.

### During this mode:

- Freezer may be adjusted. When holiday mode will be cancelled , the selected setting values will proceed.
- Cooler may be adjusted. When holiday mode will be cancelled, the selected setting values will proceed.
- Super cool and super freeze modes can be selected. Holiday mode is automatically cancelled and the selected mode is activated.
- Economy mode can be selected after cancelling the holiday mode. Then the selected mode is activated.
- To cancel, you will just need to press on mode button.



## Drink cool mode

### When would it be used?

This mode is used to cool the drinks within adjustable time.

### How would it be used?

- Press freezer button for 3 seconds.
- Special animation will start on freezer set value screen and 05 will blink on cooler set value screen.
- Press cooler button to adjust the time (05 - 10 - 15 - 20 - 25 - 30 minutes).
- When you select the time the numbers will blink 3 times on screen and sound beep beep.
- If no button is pressed within 2 seconds the time will be set.
- The countdown starts from the adjusted time minute by minute.
- Remaining time will blink on the screen.
- To cancel this mode press freezer set button for 3 seconds.

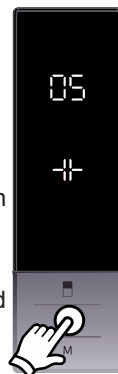

## Screen saver mode

### How to use?

- This mode will be activated when you press on mode button for 5 seconds.
- If no button is pressed within 5 seconds when the mode is active, lights of the control panel will go off.
- If you press any button when lights of control panel are off, the current settings will appear on the screen, and then you can make the adjustment as you want. If you neither cancel screen saver mode nor press on any button in 5 seconds, the control panel will go off again.
- To cancel screen saver mode press on mode button for 5 seconds again.
- When screen saver mode is active you can also activate child lock.
- If no button is pressed within 5 seconds after child lock is activated, the lights of the control panel will turn off. You can see latest status of settings or modes after you press any button. While control panel's light is on, you can cancel child lock as described in the instruction of this mode.



## Light cancelling mode

### When would it be used?

- If you want to cancel lights of cooler, you can select this mode.
- While pushing the freezer and mode buttons, open and close cooler door 3 times. The mode will be selected in this way. From now on, the lights will not come on when the function is not cancelled by the same way.
- If you want to cancel this mode, repeat the same process or the mode will automatically cancel itself after 24 hours.



## Function of Child lock

### When would it be used?

To prevent children from playing with the buttons and changing the settings you have made, child lock is available in the appliance.

### Activating Child Lock

Press on Freezer and Cooler buttons simultaneously for 5 seconds.

### Deactivating Child Lock

Press on Freezer and Cooler buttons simultaneously for 5 seconds.

**Note:** Child lock will also be deactivated if electricity is interrupted or the fridge is unplugged.



## Cooler temperature settings

- Initial temperature value for Cooler Setting Indicator is +4 °C.
- Press cooler button once.
- When you first push this button, the last value appears on the setting indicator of the cooler.
- Whenever you press on this button, lower temperature will be set. (+8°C, +6°C, +5°C, +4°C, +2°C, supercool)
- When you push the cooler set button until supercool symbol appears, and if you do not push any button in 1 seconds Super Cool will flash.
- If you continue to press, it will restart from +8°C.
- The temperature value selected before Holiday Mode, Super Freeze Mode, Super Cool Mode or Economy Mode is activated will remain the same when the mode is over or cancelled. The appliance continues to operate with this temperature value.



## Freezer temperature settings

- Initial temperature value for Freezer Setting Indicator is -18°C.
- Press freezer set button once.
- When you first push this button, the last set value will blink on screen.
- Whenever you press on this button, lower temperature will be set (-16°C, -18°C, -20°C, -22°C, -24°C superfreeze).
- When you push the freezer set button until superfreeze symbol appears, and if you do not push any button in 1 seconds Super Freeze will flash.
- If you continue to press, it will restart from -16°C.
- The temperature value selected before Holiday Mode, Super Freeze Mode, Super Cool Mode or Economy Mode is activated will remain the same when the mode is over or cancelled. The appliance continues to operate with this temperature value.



## Warnings about temperature adjustments

- Your temperature adjustments will not be deleted when an energy breakdown occurs.
- It is not recommended that you operate your fridge in environments colder than 10°C in terms of its efficiency.
- Temperature adjustments should be made according to the frequency of door openings and the quantity of food kept inside the fridge.
- Do not pass to another adjustment before completing an adjustment.
- Your fridge should be operated up to 24 hours according to the ambient temperature without interruption after being plugged in to be completely cooled. Do not open doors of your fridge frequently and do not place much food inside it in this period.
- A 5 minute delaying function is applied to prevent damage to the compressor of your fridge, when you take the plug off and then plug it on again to operate it or when an energy breakdown occurs. Your fridge will start to operate normally after 5 minutes.
- Your fridge is designed to operate in the ambient temperature intervals stated in the standards, according to the climate class stated in the information label. We do not recommend operating your fridge out of stated temperatures value limits in terms of cooling effectiveness.

- This appliance is designed for use at an ambient temperature within the 16°C - 43°C range.

Climate Class	Ambient Temperature °C
<b>T</b>	Between 16 and 43 (°C)
<b>ST</b>	Between 16 and 38 (°C)
<b>N</b>	Between 16 and 32 (°C)
<b>SN</b>	Between 10 and 32 (°C)

**Note:** If the temperature of the environment is higher than 38°C, the freezer partition temperature cannot be adjusted to -22°C and -24°C. It can only be adjusted to the values of -16°C, -18°C, -20°C.

## Accessories

### Ice box

- To remove the ice box, pull the upper freezer box out as far as possible and then pull the ice box out.
- Fill the ice box 3/4 full with water in the freezer.

**Note:** While placing the ice box in the freezer, place in a horizontal position. Otherwise the water in the ice box can be spilt.

### Freezer box

The freezer box allows food to be accessed more easily.

#### Removing The freezer box:

- Pull the box out as far as possible
- Pull the front of the box up and out.
- Carry out the opposite of this operation when re-fitting the sliding compartment.

**Note:** Always Keep hold of the handle of the box while removing it.

### Odor filter

The filter in this area blocks the bad smell in the cooler compartment.

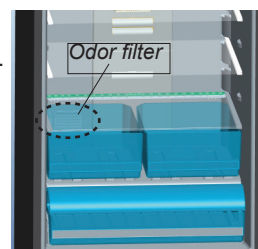
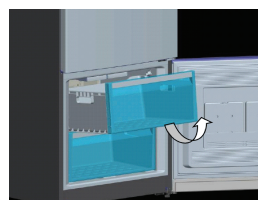
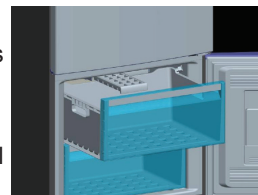

### Roller storage box

You can adjust and use this department for 2 different functions.

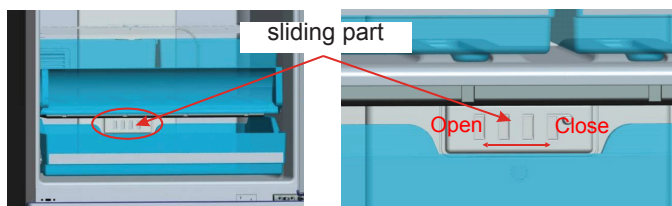

**Note:** Your fridge is delivered to you with the cover shown in the open position. Declared energy consumption and volume are defined according to the chiller option of the product.

**1. To use for 0 °C Department:** If you want to use this compartment as a 0 °C box, you must take the sliding cover (which is indicated in the picture) from the closed position to the

open position.

**2. To use for Crisper Department:** If you want to use this compartment as a crisper, you must take the sliding cover (which is indicated in the picture) from the open position to the closed position.

- While this department is used as 0 °C department, keeping food in the chiller compartment instead of the freezer or refrigerator compartment allows food to retain freshness and flavour for longer, while preserving its fresh appearance. When the chiller tray becomes dirty, remove it and wash with water. Water freezes at 0°C, but food containing salt or sugar freezes at temperatures lower than this. Normally people use the chiller compartment for storing raw fish, lightly pickled food, rice, etc...
- Pull the chiller shelf out towards you. The cover will open automatically.

**Do not put food you want to freeze or ice trays (in order to make ice) in this compartment.**

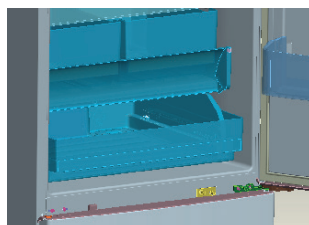

Picture 1

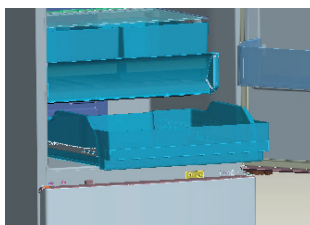

Picture 2

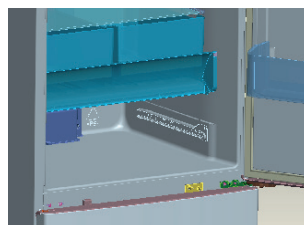

Picture 3

### **Removing The chiller shelf:**

- Open the cover fully (Picture-1)
- Pull the chiller shelf out toward you (Picture-2)
- Pull the wheels of chiller shelf up from rail to remove (Picture-3)

### **Fresh dial**

If the crisper is totally full, the fresh dial located in front of crisper should be opened. This allows the air in the crisper and humidity rate to be controlled, increasing the life of the food.

If you see any condensation on the glass shelf, you must open this dial, which is located behind the shelf.

### **Ice pack**

If a power failure or malfunction occurs, the ice pack can be used to slow down the thawing process. The longest storage time is obtained by placing the ice pack directly on the food in the top compartment.

To save space, the ice pack can be stored in the door compartment.

The ice pack can also be used to cool food temporarily, for example in a cold bag.



*Visual and text descriptions on the accessories section may vary according to the model of your appliance.*

## **PART - 3. ARRANGING FOOD IN THE APPLIANCE**

### **Refrigerator compartment**

- Food should be placed to the fridge in closed containers or covered with appropriate material.
- Hot food and beverages should be cooled to room temperature before being placed in the fridge.
- Do not store food close to the lamp, or block the cover or the cooling compartment.
- Store fruit and vegetable items loose in the crisper containers.
- Some suggestions on placing and storing of your food in the fridge compartment are given below.

### **Deep freezer compartment**

- Use the freezer for storing deep-frozen or frozen food for long periods of time and making ice cubes.
- ***If you want to use your fridge with maximum freezing capacity:***
- Place the food to be frozen into upper basket of freezer partition without exceeding freezing capacity of your fridge (for model 466).
- Place the food to be frozen into lower basket of freezer partition without exceeding freezing capacity of your fridge (for model 566).
- When using Quick Freezing mode, you should not place already-frozen food next to fresh food you want to freeze.
- After you have placed the fresh food away from the frozen, reactivate "Quick Freezing" mode. Once the food has frozen, you can place it next to the other frozen food (at least 24 hours after the 2nd activation of "Quick Freezing" mode).
- Do not store fresh food next to frozen food as it can thaw the frozen food.
- When freezing fresh food (e.g. meat, fish and mincemeat), divide it into portions that you will consume in one sitting.
- Never refreeze frozen food after it has thawed. It may be hazardous to your health and could lead to food poisoning.
- Never place warm food in the freezer compartment, as it will disturb the frozen food.
- When buying frozen food, make sure that it was frozen under appropriate conditions and the packaging is not damaged.
- When storing the frozen food, the instructions shown on the packaging should always be followed carefully and if no information is provided food should be consumed as soon as possible.
- Frozen food should be transported in appropriate containers and placed in the freezer as soon as possible. Do not use door shelves for freezing.
- If a frozen food package shows signs of humidity and abnormal swelling it is probable that it has been previously stored at an unsuitable temperature and that the contents have deteriorated. Do not buy such food.
- Storage time for frozen food may differ according to the ambient temperature, frequency of door openings, thermostat adjustments, type of food and the time elapsed between buying the food and placing the food in the freezer. Always follow instructions on the



packaging and do not exceed the storage period.

- If the freezer door is left open for a long period of time, frost may form in the freezer obstructing air circulation. To avoid this, unplug the appliance and wait for the ice to melt before cleaning the freezer.
- You can remove baskets, covers, etc. to increase storage volume of the freezer.
- The volume specified on the product label shows the value without baskets, covers, etc.

**Note:** Frozen meat should be cooked as fresh meat after being thawed. If the meat is not cooked after being thawed, it should never be frozen again.

## PART - 4. CLEANING AND MAINTENANCE

- **Disconnect the unit from the power supply before cleaning.**



- Do not clean the appliance by pouring water.



- Make sure that no water enters the lamp housing and other electrical components.
- The refrigerator should be cleaned periodically using a solution of bicarbonate of soda and lukewarm water.

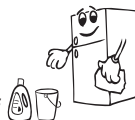

- Clean the accessories separately with soap and water. Do not clean them in the dishwasher.



- Do not use abrasive products, detergents or soaps. After washing, rinse with clean water and dry carefully. When you have finished cleaning, reconnect the plug to the mains supply with dry hands.

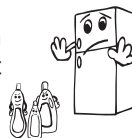

- Clean the condenser with a broom at least twice a year. This will help you to save on energy costs and increase productivity.



### THE POWER SUPPLY MUST BE DISCONNECTED.

#### Defrosting

Defrosting occurs automatically during operation. The water is collected by the evaporation tray and evaporates automatically.

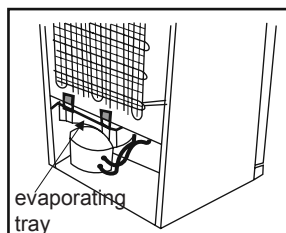

**Replacing The Light Led**  
Please call the service man.

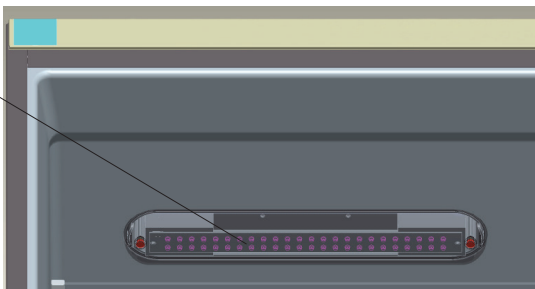

## **PART - 5. TRANSPORTATION AND CHANGING OF INSTALLATION POSITION**

### **Transportation and changing of installation position**

- The original packages and foamed polystyrene (PS) can be retained if required.
- During transportation, the appliance should be secured with a wide string or a strong rope. The instructions written on the corrugated box must be followed while transporting.
- Before transporting or changing the installation position, all the moving objects (ie,shelves,crisper...) should be taken out or fixed with bands in order to prevent them from getting damaged.

***Carry your fridge in the upright position.***

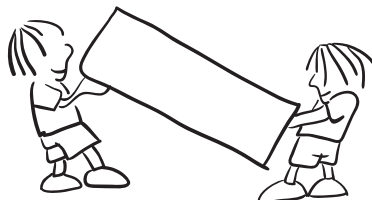

### **Repositioning the door**

- It is not possible to change the opening direction of your refrigerator door, if the door handle on your refrigerator is installed from the front surface of the door.
- It is possible to change the opening direction of the door on models without any handles.
- If the door opening direction of your refrigerator may be changed, you should contact the nearest Authorised Service Agent to have the opening direction changed.

## PART - 6. BEFORE CALLING YOUR AFTER SALES SERVICE

### Check warnings;

Your fridge warns you if the temperatures for cooler and freezer are in improper levels or when a problem occurs in the appliance. Warning codes are displayed in the Freezer and Cooler Indicators.

ERROR TYPE	MEANING	WHY	WHAT TO DO
<b>SR</b>	"Failure Warning"	There is/are some part(s) Out of order or there is a failure in cooling process	Call Service for assistance as soon as possible.
<b>SR – Set value blink on freezer set value screen</b>	Freezer comp. Not Cold enough	This caution will be seen especially after long term of power failure	<ol style="list-style-type: none"> <li>1. Do not freeze the foods that are thaw and use in short time period.</li> <li>2. Set the freezer temperature to colder values or set the super freeze , until the compartment gets to normal temperature.</li> <li>3. Do not put fresh food until this failure is off.</li> </ol>
<b>SR – Set value Blink on cooler set value screen</b>	"Refrigerator comp. Not Cold enough"	Ideal temperature for Ref. Compartment is +4 °C. If you see this warning your foods have risk of spoiling.	<ol style="list-style-type: none"> <li>1. Set the refrigerator temperature to colder values or set the super cooling mode until the compartment gets to normal temperature.</li> <li>2. Do not open the door much until this failure is off.</li> </ol>
<b>SR – Set value blink on freezer and cooler set value screen</b>	"not cold enough Warning"	It is combination of "not cool enough" error for both of the compartments.	You will see this failure when first starting the appliance. It will be off after the compartments gets normal temperature
<b>SR – Set value blink on cooler set value screen</b>	Refrigerator comp. too Cold	The foods starts to freeze because of the too much cold temperature	<ol style="list-style-type: none"> <li>1. Check if the "Super cooling mode" is on</li> <li>2. Decrease the refrigerator temperature values</li> </ol>
<b>"_ _"</b>	"Low voltage Warning"	When the power supply gets lower than 170 V the appliance gets to steady position.	This is not a failure. This prevents any damages on the compressor. This warning will off after the voltage gets required level

**If your fridge is not operating:**

- Is there an electrical fault?
- Is your appliance plugged in?
- Is the fuse of the socket or the main fuse blown?
- Is there a fault with the socket? Examine this by plugging your fridge into a socket which you are sure is working.

**If your fridge is operating too loudly:****Normal noises****Cracking (Ice cracking) Noise:**

- During automatic defrosting.
- When the appliance is cooled or warmed (due to expansion of appliance material).

**Short cracking:** Heard when the thermostat switches the compressor on/off.

**Compressor noise (Normal motor noise):** This noise means that the compressor operates normally. The compressor may cause more noise for a short time when it is activated.

**Bubbling noise and splashing:** This noise is caused by the flow of refrigerant in the tubes of the system.

**Water flow noise:** Normal noise of water flowing into the evaporation container during defrosting. This noise can be heard during defrosting.

**Air Blow Noise:** Normal fan noise. This noise can be heard in a No-Frost fridge during normal operation of the system, due to the circulation of air.

**If the edges of fridge cabinet that touch the door joint are warm:**

In hot weather, the surfaces of the joint contact may get warmer during operation of the compressor. This is normal.

**If humidity builds up inside the fridge:**

- Is the food packed properly? Are the containers dry before being placed in the fridge?
- Are the fridge doors opened frequently? Humidity of the room gets in the fridge when the doors are opened. Humidity build up will be faster when you open the doors more frequently, especially if the humidity of the room is high.

**If the doors do not open and close properly:**

- Do the food packages prevent the door from closing?
- Are the door compartments, shelves and drawers located properly?
- Are door gaskets broken or torn?
- Is your fridge on a level surface?

**If your fridge is not cooling sufficiently enough:**

See page 11. (Warning regarding temperature settings).

**IMPORTANT NOTES:**

- The compressor protection thermal fuse will blow after a sudden loss of power or after the appliance is unplugged. This is because the gas in the cooling system has not stabilised and is nothing to worry about. Your fridge will start within 5-10 minutes.
- If you do not intend to use your fridge for a long time (e.g. in summer holidays) unplug it and clean once defrosting has taken place (see SECTION 4). Leave the door open to prevent humidity and smells.

- **If a problem persists after you have followed all the instructions above, please consult to the nearest** Authorised Technical Service Centre.
- The appliance you have purchased is designed for domestic use and can only be used at home and for the stated purposes. It is not suitable for commercial or common use. If the consumer uses the appliance in a way that does not comply with this, we emphasise that the manufacturer and the dealer will not be responsible for any repair or failure within the guarantee period.

## **Tips for saving energy**

1. Install the appliance in a cool, well ventilated room , but not in direct sunlight and not near a heat source (radiator, cooker.. etc). Otherwise use an insulating plate.
2. Allow warm food and drinks to cool down outside the appliance.
3. When thawing frozen food, place it in the refrigerator compartment. The low temperature of the frozen food will help to cool the refrigerator compartment when it is thawing. This will help to save energy. If the frozen food is put out, it results in a waste of energy.
4. Cover drinks or other liquids when placing them in the appliance. Otherwise humidity increases in the appliance. Therefore, the working time gets longer. Also covering drinks and other liquids helps to preserve smell and taste.
5. Try to avoid keeping the doors open for long periods or opening the doors too frequently as warm air will enter the cabinet and cause the compressor to switch on unnecessarily often.
6. Keep the covers of the different temperature compartments (crisper, chiller ...etc ) closed
7. Door gasket must be clean and pliable. Replace gaskets if worn.

## PART - 7.

## THE PARTS OF THE APPLIANCE AND THE COMPARTMENTS

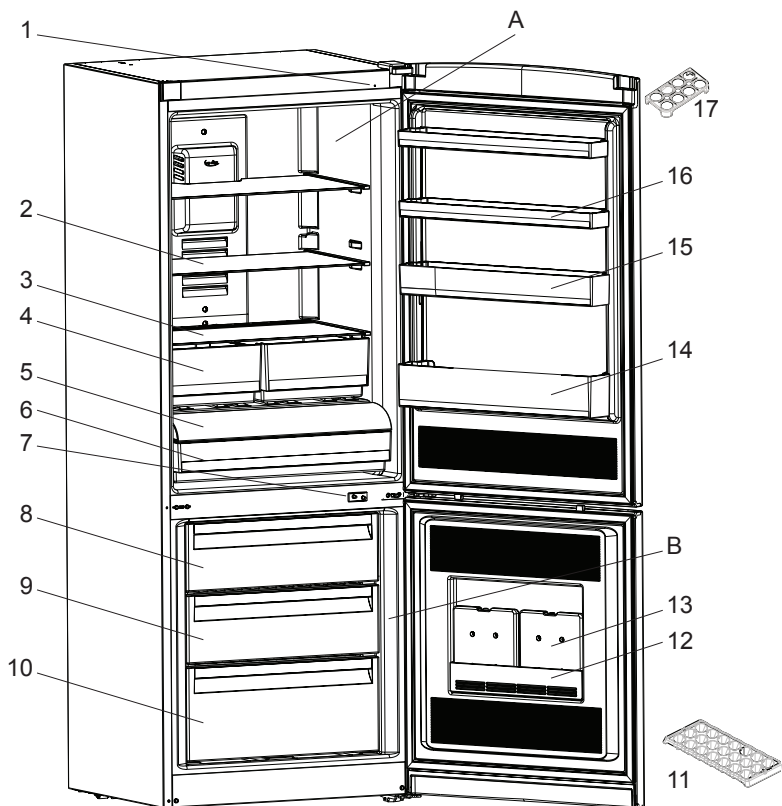

This presentation is only for information about the parts of the appliance.  
Parts may vary according to the appliance model.

A) Fridge compartment  
B) Freezer compartment

- |                                     |                              |                         |
|-------------------------------------|------------------------------|-------------------------|
| 1) Light sensor                     | 7) Light key                 | 13) Cooling accumulator |
| 2) Fridge glass shelf               | 8) Freezer upper basket      | 14) Bottle shelf        |
| 3) Crisper cover                    | 9) Freezer middle basket     | 15) Medium shelf        |
| 4) Crispes                          | 10) Freezer lower basket     | 16) Upper shelf         |
| 5) Railed storage compartment cover | 11) Ice tray                 | 17) Egg shelf           |
| 6) Railed storage compartment       | 12) Cooling accumulator slot |                         |